

Takara Belmont Barber Chair

DIVAN-Z

Model No. AB-DVZF

Operation Manual



Thank you for purchasing this Takara Belmont product.

Be sure to read this operation manual before operating the chair and always operate the chair properly according to the instructions herein.

Failure to read this operation manual may lead to accidents.

- Carefully store this operation manual in a secure location near this product where they can be readily accessed, and refer to them whenever necessary.
- This product is a barber chair designed for the services offered at hair salons. Do not use this product for any purposes other than those described above. This product shall be operated only by qualified hairdressers.
- Ask your authorized Takara Belmont dealer to install this product.

Please contact Takara Belmont with the BOOK No. (outlined below) if this operation manual becomes torn or damaged and unreadable, or is lost.

Contents

Introduction

Explanation of Warning Labels	3
Safety Precautions	4
Use Precautions	9
Precautions Related to Synthetic Leather	11
Locations of Warning Labels	11
Accessories	11
Part Names	12

Preparation

Turn on power	14
---------------------	----

How to Use

Rotating the Chair	15
Adjusting the headrest	16
Raising/Lowering the Chair	18
Reclining/Raising the Backrest	19
Raising/Lowering the Legrest	20
Moving the Chair to Preset Positions	21
Using the Cape Holder	25
Using the Dryer/Iron Holder	26
Using the Service Outlets	27
About shockless move	28
Using the Heater	28
Using Fans	29
Using the fold-out table	30
Using the Foot Cushion (Optional)	31
Using the Footrest Pad (Optional)	31
Removing the Footrest	32

Care and Maintenance

Cleaning Procedures	33
---------------------------	----

When Necessary

Troubleshooting	34
Daily Inspection	35
Standard Period of Use	36
Disposing of this Product	36
Specifications	37

Explanation of Warning Labels

■ Before Use

Be sure to read "Safety Precautions" and "Precautions for Use" carefully before use.



■ About the Precautions Listed Here

The precautions continued herein are in order to ensure safe use, and to prevent any injury to users and other persons, and to prevent any damage.





The precautions are categorized into "WARNING" and "CAUTION" according to the level of hazard and damage and the degree of urgency which may occur if the product is used improperly. To ensure safety, adhere to these precautions at all times.

Takara Belmont has absolutely no responsibility for accidents that might be caused by failure to obey "Safety Precautions" and "Use Precautions" resulting in injury to users and other persons, or other damage. In this case, those using the product without observing "Safety Precautions" (and "Precautions for Use") will be responsible for these hazards and damages.

A detailed explanation of the cautionary symbols is provided below. Be sure that you fully understand their contents before reading the rest of this manual.

Classification of Precautions	Level of Harm and Damage, and Degree of Urgency
 WARNING	This indicates that failure to obey the corresponding warning and the resulting improper operation can result in death or serious injury.
 CAUTION	This indicates that failure to obey the corresponding warning and the resulting improper operation can result in mild injury, or moderate harm and damage.

The following symbols are used to describe specific indications that you must obey.

Prohibited Action Symbol	Mandatory Action Symbol
 Indicates generally prohibited actions.	 Indicates actions by general users that must be performed.
 Indicates that disassembly, repair and modification are prohibited.	 Indicates that the power plug must be removed from the socket.

Safety Precautions

WARNING

Power Plug and Cord



Do not connect the earth (ground) to the following objects.

- Water pipes
(Complete grounding is not possible as hard plastic pipes are widely used.)
- Gas pipes (Can result in an explosion or fire)
- Lightning rods and telephone dedicated grounding wire (Dangerous during lightning)

Do not plug or unplug with wet hands.

Touching the power plug or outlet with a wet hand can result in electric shock.



Use an unshared outlet that has an attached ground terminal and matches the rated voltage and current *of this product.

Using the same outlet together with the power plug of other devices can result in abnormal heat generation and possible fire.

* 110-240V AC (12 A or more).

Firmly insert the power plug into the outlet.

Be sure to fully insert the power plug into the outlet until reaching the base of the plug.

Failure to fully insert the plug or similar fault can result in a short circuit or heat generation that causes a fire.

If there is dust on the power plug or wall outlet, wipe it well with a dry cloth.

Continued use may cause fire.

Hold by the power plug when unplugging.

Do not pull the cord to remove the power plug from the outlet. Hold by the power plug at the end of the cord when removing. Removing the plug by pulling the power cord can damage the power cord, resulting in electric shock or fire.

Handle the power cord with care.

Damage to the power cord may result in electric shock or fire.

- Do not damage the cord.
- Do not tamper with the cord.
- Do not forcibly bend, twist, or pull the cord.
- Do not place anything on the cord.
- Do not heat the cord.

Be careful of power cord or plug breakage.

Do not use any power cord or plug that is damaged, or that fits loosely when inserted into an outlet.

Doing so can result in electric shock or fire.

Securely connect to ground.

Failure to make a ground connection can result in electric shock if there is a malfunction or short circuit. Consult an electrician for grounding procedures.



Unplug the power plug when the chair is not in use.

Turn off the power switch and remove the power plug from the outlet when the chair is not to be used for a long period of time, such as at the end of work or during holidays.

Unexpected operation can result in an accident or fire from a short circuit due to insulation aging.

Installation/Transport



Installation precautions

- Ask your authorized Takara Belmont dealer to install this product.
- The chair must be installed on a perfectly flat and solid floor.
Installing the chair to a non-flat floor can result in the chair tipping over.

Safety Precautions

WARNING

Use and Cleaning Precautions



Be careful to keep hands, fingers and other body parts of the customer and user from touching or getting close to moving parts.

Doing so may cause the unit to have them pinched, resulting in injury.

Customer must not lie on his/her stomach, put his/her legs or feet on the seat, or sit on the product with a child in his/her arms.

The chair may move unexpectedly, causing injury.

Not getting on the front edge of the seat or footrest.

The chair may fall or move unexpectedly, causing injury or damage to peripheral devices or facilities.

Not sitting on or applying excessive load to any place other than the designated place.

Do not sit on or apply excessive load to headrest, armrests, backrest, legrest, or footrest.

Failure to do so may cause injuries due to the product falling over or damage to peripheral equipment or facilities.

Do not wash the chair by pouring water on it.

Washing in such a manner can result in a malfunction or electric shock.



Do not disassemble, repair or modify the chair.

• Disassembly or repair must only be done by a qualified service staff. Disassembly by yourself can result in an accident, a malfunction, electric shock or fire.

• Never modify this product. Doing so is dangerous.



Precautions when seating customers.

• As shown in the figure below, have the customer sit down.

When operating the product, make sure that the customer's posture is maintained as shown in the figure below.

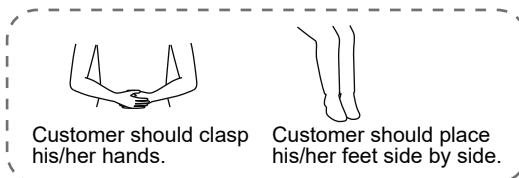

• For small children, when raising the backrest, the hips should be shifted to the correct position in the seat.



Remove customers' glasses and accessories (necklaces, bracelets, etc.) before services as they may interfere with hairdresser or cause injury.

Precautions regarding customers and children

• Be careful to closely watch customers when using this chair. Customers (especially children) may touch the control switch inadvertently, leading to an unexpected accident due to incorrect operation of the product.

• Only allow children near this chair when they are getting their hair cut.

Safety Precautions



Use and Cleaning Precautions



Precautions when getting in and out of the chair

- When the customer gets on or off the chair, the chair should always be at entry/exit position (auto return position) with the chair rotation locked.
- Before moving the customer from a wheelchair to DIVAN-Z or vice versa, ensure that not to place the wheelchair within operation range. Contact of the feet or the wheelchair casters with obstacles (such as foot switch) may cause sudden move of the chair, leading to injury or damage to peripheral equipment and devices.
- When the customer is moved from a wheelchair to DIVAN-Z or vice versa, he/she or the chair must be carefully monitored to prevent falling.
- If the customer has to get off DIVAN-Z at a position - due to power failure or in the event of an emergency - other than the designated position for getting on and off DIVAN-Z, he/she or the chair must be carefully monitored to prevent falling.

Precautions when reclining/raising the backrest

- When raising/reclining the backrest, make sure that there are no hand or fingers of the customer between the backrest and the body/seat.
- Carefully recline the backrest so that the headrest or backrest will not contact any shampoo bowl or nearby equipment.
- When the backrest is laid down, the body lowers in conjunction with it. Be careful not to pinch your body or objects under the body or between the body and the pump cover.

Precautions for chair operation

- Before operating the chair and during operation, thoroughly check that there are no bodies or limbs of persons, or possible obstacles in the operating range of the chair (ranges of seat raising/lowering, backrest reclining/raising, legrest operating directions, and seat rotation) or nearby. It may become caught in the chair, causing injury or damage to peripheral equipment or facilities.
- When operating the product, make sure that the customer is sitting in the correct posture and position, and keep an eye on the customer during operation.

Precautions during chair rotation

- Make sure that no persons or objects are nearby before slowly rotating the chair.
- When the backrest is fully reclined, rotate it with attention to the position in which the customer is lying and the posture of his/her body and limbs.
- After rotation, be sure to lock the chair base.

Caution when raising and lowering the legrest

- When raising the legrest, make sure that customer's toes or the footrest does not come in contact with peripheral equipment.
- When lowering the legrest, make sure that there is no person or object under the legrest or footrest.

Precautions when removing/installing the footrest

- After installing the footrest, make sure that the footrest bracket is firmly hooked to the footrest mount and that the footrest is kept level. Failure to do so may result in injury.
- Be careful when lifting and carrying the footrest, and of where you place it because the footrest is heavy. Dropping the footrest could result in injury or damage the floor.

Safety Precautions



Use and Cleaning Precautions



Precautions for the service outlets

- Be sure to fully insert the power plug of the device being used into the outlet until reaching the base of the plug. Failure to fully insert the plug or similar loose connection can result in a short circuit or heat generation that causes a fire.
- If the connection becomes loose, immediately stop using the equipment attached to the service outlet and unplug the equipment from the service outlet. Contact your authorized Takara Belmont dealer as soon as possible for inspection or replacement parts.
- Remove the power plug of a device from the outlet when not using it.
- If any water gets on a service outlet, immediately turn off the chair power switch, remove the plug, and wipe away the water. Additionally, if a substantial amount of water gets inside a service outlet, immediately remove the plug and contact your authorized Takara Belmont dealer.
- Do not touch a service outlet with a wet hand.
- If needed, use a suitable conversion adapter as AC250V 12A or higher.
- When a conversion adapter is used, make sure that it is firmly plugged into the service outlet. Loose connection can make the adapter heated up and lead to fire.

Precautions when using the heater

- Be sure to turn off the heater switch when not necessary. Using the heater for an extended period causes the temperature to increase, possibly resulting in burns or fire.
- Do not use the heater for a long time. Doing so may cause low-temperature burns. Should red spots or blister occur, immediately take the diagnosis of a medical specialist.
- If you notice abnormal heat when using the heater, turn off the power switch, unplug the equipment, and contact your authorized Takara Belmont dealer.

Precautions when using in an environment where electromagnetic waves exist

Do not install the chair near equipment that generates electromagnetic waves such as communication equipment and elevators. Do not use devices that generate electromagnetic waves near this chair. Doing so can result in faulty operation.

Be sure to always perform daily inspection.

Failure to do so may result in injury or damage to peripheral equipment or facilities. Refer to "Daily Inspection" on p. 35.

Stop using the product if it fails.

If the product should fail, stop using it immediately, turn off the power switch, disconnect the power plug, and contact your authorized Takara Belmont dealer for repair.



Turn off the power switch and unplug the power plug before cleaning.

Failure to do so can result in electric shock or fire. Unexpected activation of the product may cause injury.

Procedures if a power outage occurs

Turn off the power switch and remove the power plug of this product from the outlet in order to prevent unexpected operation when recovering from a power outage. Also turn off the power switches of all devices connected to the service outlet and remove the power plugs of devices.

Safety Precautions



Use and Cleaning Precautions



Do not allow any person whose weight exceeds 135 kg to sit in the chair.

Doing so can cause the chair to tip over or faulty operation.



Ensure that each part works properly before use.

Be constantly careful of and inspect for looseness, rattling, tilting, vibration, noise, temperature, odors and other possible problems. If you feel that something seems slightly different or not normal, immediately stop using the chair, turn off the power and unplug the power plug, and contact your authorized Takara Belmont dealer.

Always be sure to use your hands to operate the switches.

Be sure to operate the switch by hand, except for the foot-operated switch. Operation with other than hands may cause damage or unexpected operation.

Be extremely careful not to mistake the switches when operating.

Pay full attention to the surroundings and advise the customer before operation of the expected chair movement to avoid any injury.

Precautions when using the headrest

- Be careful in pulling up the headrest more than necessary because doing so will make the headrest to come off the chair.
- Wipe off all water and chemicals immediately if any gets on the headrest bar. Failure to do so can prevent the headrest from being securely fixed because of corrosion or degradation of friction force due to rust.
- Be careful when operating the headrest that fingers and other body parts are not pinched between the area around the operating lever or in between the headrest and backrest.
- Be careful not to catch customer's hair or clothing when storing the headrest.

Precautions when using the cape holder

- Be sure to store the cape holder when it is not used.
- When storing the cape holder, be careful not to get your or the user's fingers caught between the armrest and the cape holder.
- Use of the cape holder beyond its load capacity (1kg) may result in damage or injury, etc.

Precautions when adjusting the footrest adjuster

When adjusting the height of the adjuster, make sure that the adjuster does not rub on the floor or catch the power cord when the chair is rotated. On the contrary, adjust the height so that the product does not fall over even if the customer gets on the footrest at exit/entry position.

Precautions when using the dryer/iron holder

- Be careful not to let the operator's feet come in contact with the dryer/iron holder.
- Use of the dryer/iron holder beyond its load capacity (5kg) may result in damage or injury.

Precautions when using the fan

When using the fan, make sure that the customer is not hanging a small object such as a key or a portable strap on the waist. If foreign matter enters into the air outlet of the fan inside the armrest may cause failure of the fan or property damage.

Precautions when using a fold-out table

When inserting or pulling out the table, hold it with both hands until the end and operate it slowly. Be careful not to get the fingers/hands of customer/operator caught in the retractable table.

Precautions when using a foot cushion (optional)

Remove the foot cushion from the footrest when the customer gets in and out of the chair. Otherwise the customer may fall over causing injury.

Safety Precautions



Use and Cleaning Precautions



Be careful not to trip on the power cord.

It may cause injury.

Immediately wipe off any chemical solutions or water that spills on the chair.

Water or chemical adhering to a service outlet or control panel can result in faulty operation or a short circuit. Immediately turn off the power switch, and wipe off any chemical or water that has adhered to the product by using a dry soft cloth.

Precautions for cleaning procedures

The metal and mechanical parts of the chair have sharp edges. Be careful when cleaning the chair that your hands, fingers or other body parts are not injured.

Turn off the power switch at the end of day or during recess.

Injury or damage may result from operation due to unexpected contact.

Use Precautions

Immediately wipe off any chemical that spills on the chair.

Failure to do so can result in deformation or discoloration.

Do not apply heat

Doing so can result in deformation or discoloration.

Discoloration of resin

Resin materials are used in external components of this product. Carefully selected materials are used; however, discoloration may occur for reasons such as natural deterioration or the adherence of solutions. To ensure use of the product for longer period, immediately wipe off any solutions if it adheres, and avoid sunlight.

Do not place any objects other than persons in the seat.

Other objects can result in deformation or tearing of the leather, or corrosion.

Do not strongly strike or scrape the chair.

Doing so can result in damage, and faulty operation.

Do not push the backrest forward.

This may cause malfunction.

Recline the backrest at the end of the day

When you have finished working for the day, lower the chair to the lowest position and completely recline the backrest. This helps to extend the service life of the chair by not applying a load to springs and cylinders.

Do not use this chair for any applications other than hairdressing/beauty-related procedures.

This product is designed for commercial use in barber shops and beauty salons.

Only persons who are certified hairdressers or beauticians can be allowed to use this chair.

Do not use outdoors.

Doing so can result in damage.

Contact your authorized Takara Belmont dealer if the breaker function (p. 34) frequently operates.

Maximum load (maximum lifting capacity) is 135kg.

The lifting speed of the chair may change or the operation noise may increase depending on the weight of the customer.

Use Precautions

Operate the fan once a month

Even if the fan is not used for a long period of time, operate the fan once a month. If dust or hair accumulates inside the fan, dust or hair may come out when the fan is running, or the fan itself may cause malfunction.

Pay attention to the natural wood part

Do not hit the natural wood part with a hard object such as scissors. Wood may be chipped or scratched.

Materials Used

The wood section of the product uses natural wood.

The wood surface is finished with urethane paint. Even if the paint is of the same color, the wood grain pattern and color tone differ one by one depending on the parts to be used. Understand the features and characteristics of natural wood that are different from mass-produced products such as artificial building materials that use printed surface sheets.

Precautions Related to Synthetic Leather

Clothing dye adhering

The color of clothing or belts can be transferred to the synthetic leather of this chair by means of contact. If color adheres to the leather, wipe off the stain as soon as possible before it soaks in by using a soft cloth that has been dabbed with a neutral detergent diluted with water to approximately one tenth, wipe it with a damp cloth and thoroughly wipe it dry.

Precautions regarding deformation and color transfer due to contact

- Contact with other plastic parts, painted items, solvents, adhesive tape and similar items can result in changes in surface luster, cracking, deformation and peeling.
- Contact with newspaper or other printed items can result in color transfer.
- Contact with printed clothing such as t-shirts, jeans and similar items can result in color transfer such as by dye adhering to the leather.
- Adhering benzene, nail polish remover, alcohol, oil and similar substances can result in discoloration, surface dissolution, changes in luster, hardening or softening and peeling.
- Use of bleach, or use of a sheet or other cloth for which bleach has been used can result in changes in luster and color.
- Placement of an iron, heater or other excessive heat source near the chair can result in deformation and discoloration.
- Use a curtain or similar item to block the chair from exposure to direct sunlight. Exposure to direct sunlight can result in surface deformation, shrinking, discoloration, faded colors and similar problems.
- Placement of a heavy item for an extended period can result in marks or wrinkles that do not disappear after removing the item.

Leather wrinkle processing

The wrinkles in the design result in an irregular wrinkling process called gathering. Because of the irregular wrinkling process, the amount and length of wrinkles are different one by one. Gathering also varies depending on the type of leather, color, and lot.

Locations of Warning Labels



⚠ WARNING / AVERTISSEMENT			
Risk of pinching during the operation. Check the space below and around the chair when raising or lowering the chair and the legrest.	Risk of dropping of the pump. Carry the chair with holding the base and the foot pedal.	Risk of malfunction or a fire caused by a short circuit. Unplug the power cord when not used.	Risk of electric shock, fire, and abnormal motion. Do not disassemble, repair or modify.
Risque de pincement durant l'opération. Vérifier l'espace en dessous et autour de la chaise lors de l'élévation ou de la descente de la chaise ainsi que du repose jambes.	Risque d'échapper la pompe. Transporter la chaise en soutenant la base et la pédale.	Risque de malfonction ou incendie causée par un court-circuit. Débrancher le cordon d'alimentation lorsque non-utilisé.	Risque de choc électrique, incendie ou opération anormale. Ne pas désassembler, réparer ou modifier.

Refer to the Operation Manual for other notes.

Accessories

- Operation manual (this manual) 1 copy
- Installation manual 1 copy
- DIVAN-Z Attaching the provided protective stickers 1 copy
- Protective sticker for armrest 1 set (right and left)
- Protective sticker for table 1 sheet

Part Names

Main Unit

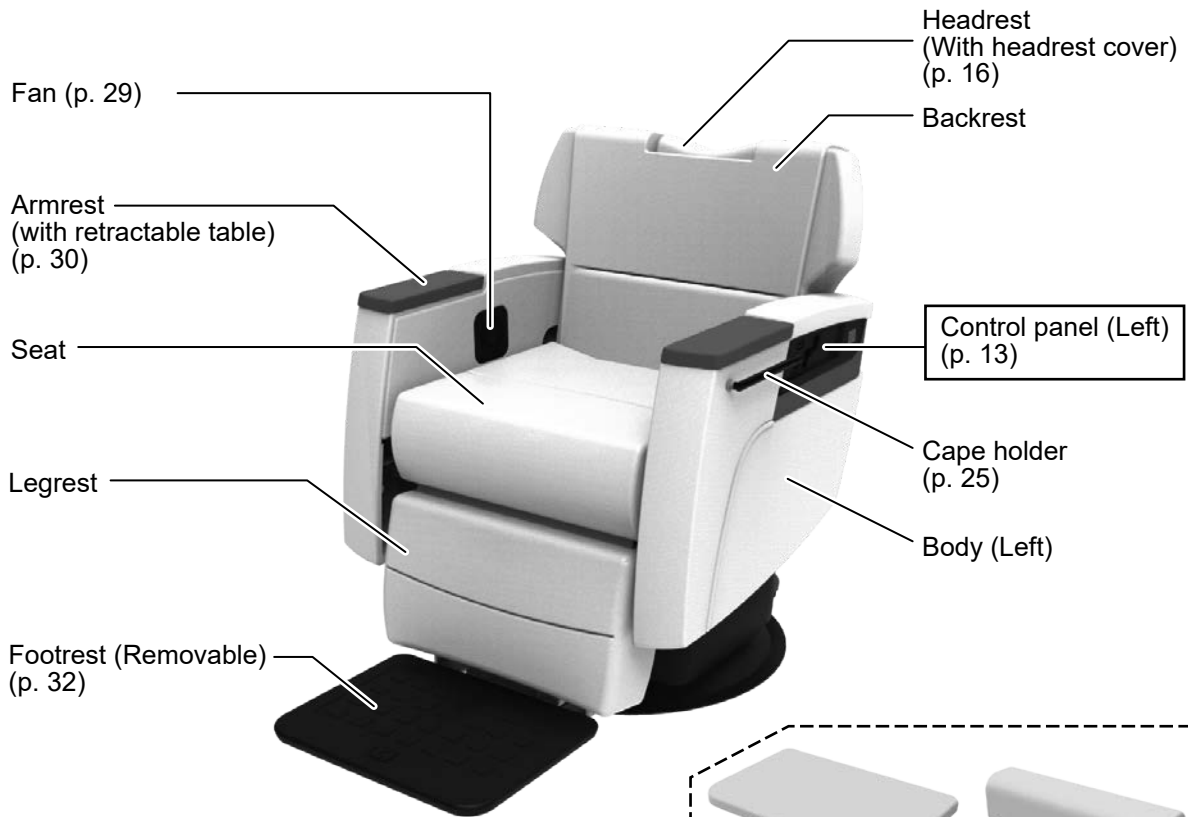

Attach the provided protective sticker (for preventing scratches) to the armrest and fold-out table before use. (Refer to the separate sheet "DIVAN-Z Attaching the provided protective stickers")

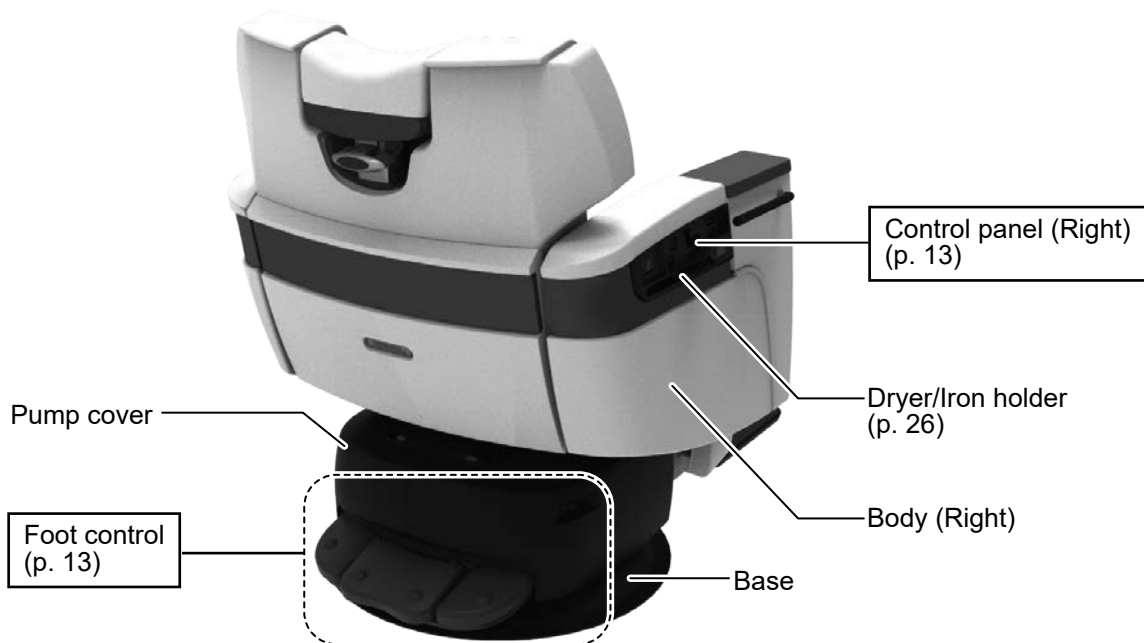
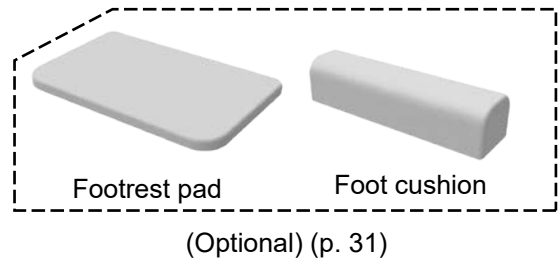

Part Names

Control Panels

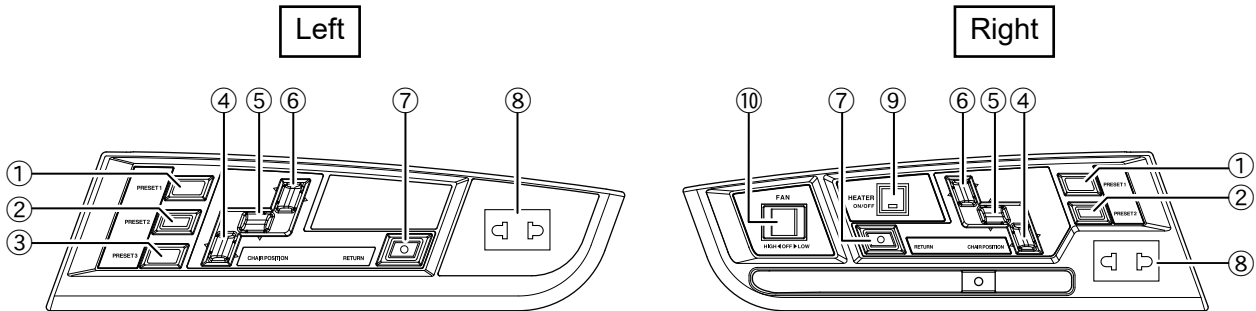

- ① Preset switch P1
- ② Preset switch P2
- ③ Preset switch P3
- ④ Legrest switch
- ⑤ UP/DOWN switch
- ⑥ Backrest switch

- ⑦ Auto-return switch
- ⑧ Service outlet
- ⑨ Heater switch
- ⑩ Fan switch

Foot Control

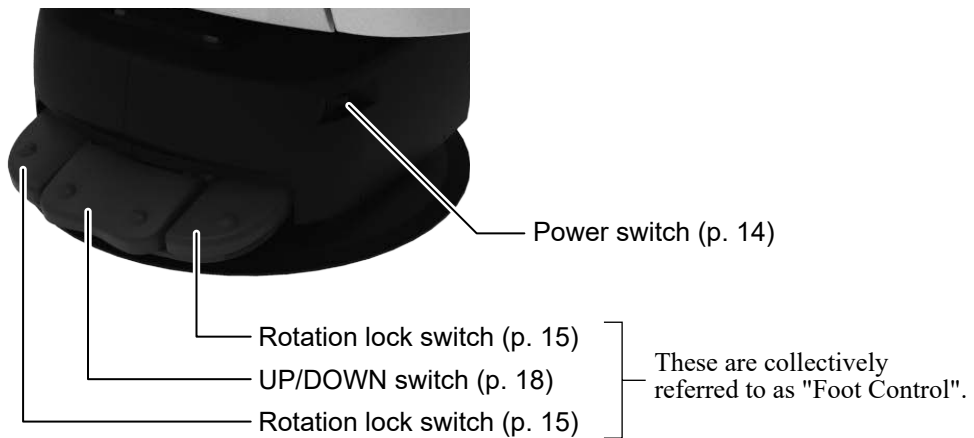

Turning on power

Inserting the power plug into the outlet

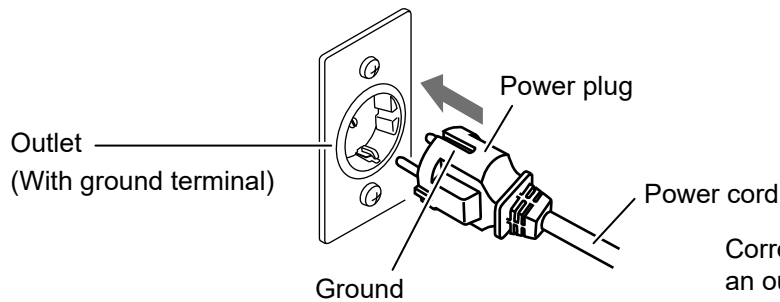

Correctly insert the power plug into an outlet with a ground terminal.

WARNING

- Use an unshared outlet that has an attached ground terminal and matches the rated voltage and current *of this product. Using the same outlet together with the power plug of other devices can result in abnormal heat generation and possible fire.
* 110-240V AC (12 A or more).
- Be sure to fully insert the power plug into the outlet until reaching the base of the plug.
- Do not pull the cord to remove the power plug from the outlet. Hold by the power plug at the end of the cord when removing.
- Do not touch the power plug or outlet with wet hands.
- Do not connect the earth (ground) to the following objects.
Water pipes, Gas pipes, Lightning rods and telephone dedicated grounding wire
- Securely connect to ground. Consult an electrician for grounding procedures.
- Turn off the power switch and remove the power plug from the outlet when the chair is not to be used for a long period of time, such as at the end of work or during holidays.

Turning on power

Press the side with the | mark to turn the power on and the side with the ○ mark to turn the power off.

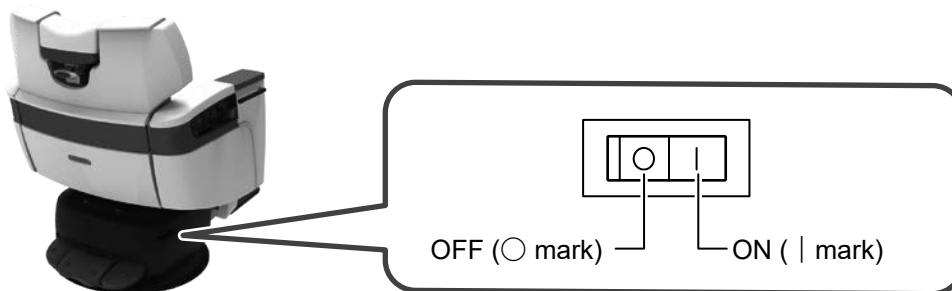

The warm-up mode may be activated to start the warm-up operation when the hydraulic oil temperature and the room temperature is low. (p. 28)

⇒When the power is turned on, the chair rotation is locked automatically.

 **CAUTION** Always operate the power switch by your hands only.

Rotating the chair

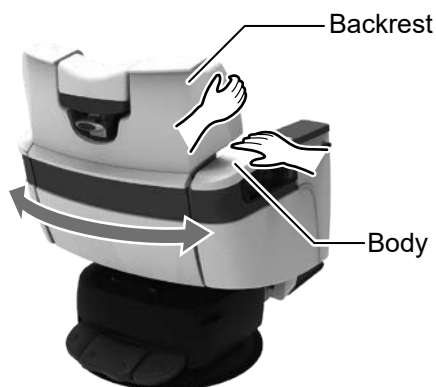
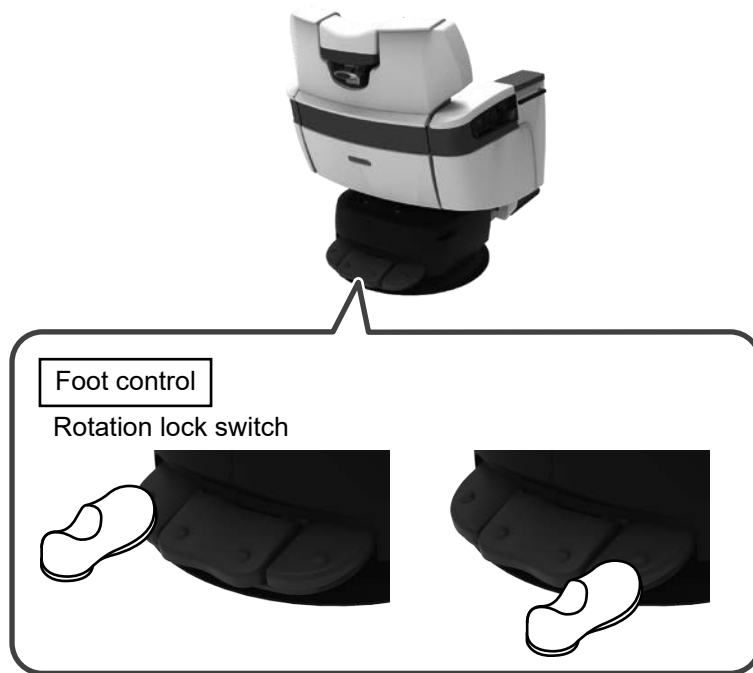

Hold the backrest or body when rotating the chair.
(You can rotate the chair a full 360°.)

When the rotation is locked, stepping on the rotation lock switch to unlock it.
Each stepping of the rotation lock switch alternately locks and unlock the rotation.

⇒ When the rotation is in the unlocked state, the rotation is locked by performing the following operation:

- Turn on the power switch.
- Press the switches on the foot control and control panel (except for the legrest heater switch and fan switch).

WARNING

- When the customer gets on or off the chair, the chair should always be at entry/exit position (auto return position) with the chair rotation locked.
- Make sure that no persons or objects are nearby before slowly rotating the chair.
- When the backrest is fully reclined, rotate it with attention to the position in which the customer is lying and the posture of his/her body and limbs.
- After rotation, be sure to lock the chair base.

Adjusting the headrest

Use the headrest when supporting the customer's head is needed, such as for shaving.
Tip the headrest forward to fit it against the customer's head so that the customer will be more comfortable even if used for an extended period.

1. Lift up the handle and pull up the headrest.

Remove your hand at the desired position to lock the headrest there. If the headrest is pulled too far up, return it while pressing the headrest operation lever.

Do not press the headrest operation lever when pulling up the headrest from its stored position. It makes the headrest fall forward when the headrest is pulled up and may interfere with the backrest, causing damage to the leather of the backrest.

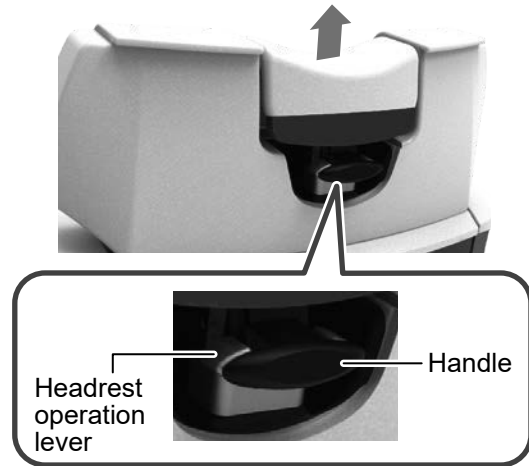

2. While pressing the headrest operation lever, tip the headrest forward.

Headrest can be tilted forward only at 90°. Push the headrest over so it is at 90 degrees and release the headrest operation lever.

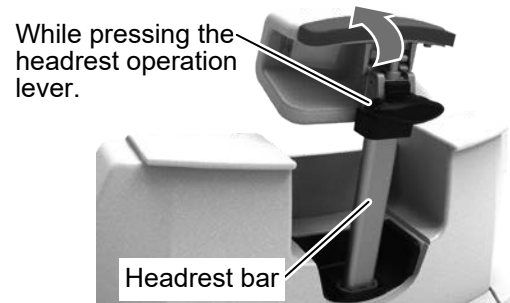

3. Store the headrest when finished using it.

- ① While holding the handle and pressing the headrest operation lever, return the headrest to its original angle.
- ② Lower the headrest.

Move the headrest back to the original angle, and then lower the headrest. If the headrest is lowered being tilted forward, it may interfere with the backrest, causing damage to the leather of the backrest.



- Do not apply excessive load or shock to the headrest. Doing so can result in damage.
- Be sure to always store the headrest when performing a back shampooing. Otherwise, the shampoo bowl will interfere with the headrest possibly resulting in breakage.

CAUTION

- Be careful in pulling up the headrest more than necessary because doing so will make the headrest to come off the chair.
- Be careful not to get water or any chemical on the headrest bar. Wipe off all water and chemicals immediately if any gets on these parts. Failure to do so can prevent the headrest from being securely fixed because of corrosion or degradation of friction force due to rust.
- Be careful when operating the headrest that fingers and other body parts are not pinched between the area around the operating lever or in between the headrest and backrest.
- Be careful not to catch customer's hair or clothing when storing the headrest.

Adjusting the headrest

Detaching/Attaching the headrest

If you do not use the headrest, you can remove it by pulling it out.

When attaching, insert the hole of the headrest support frame into the lock support bar while pressing the headrest operation lever, aligning the guide.

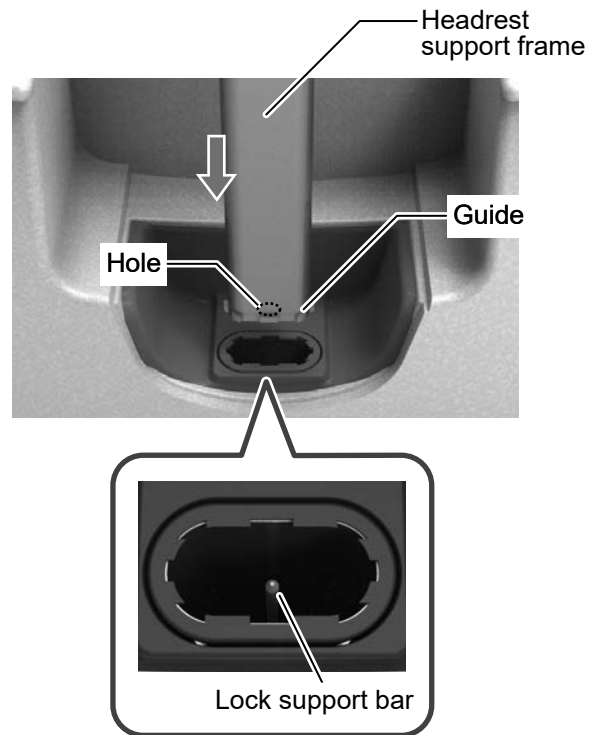

Raising/Lowering the Chair

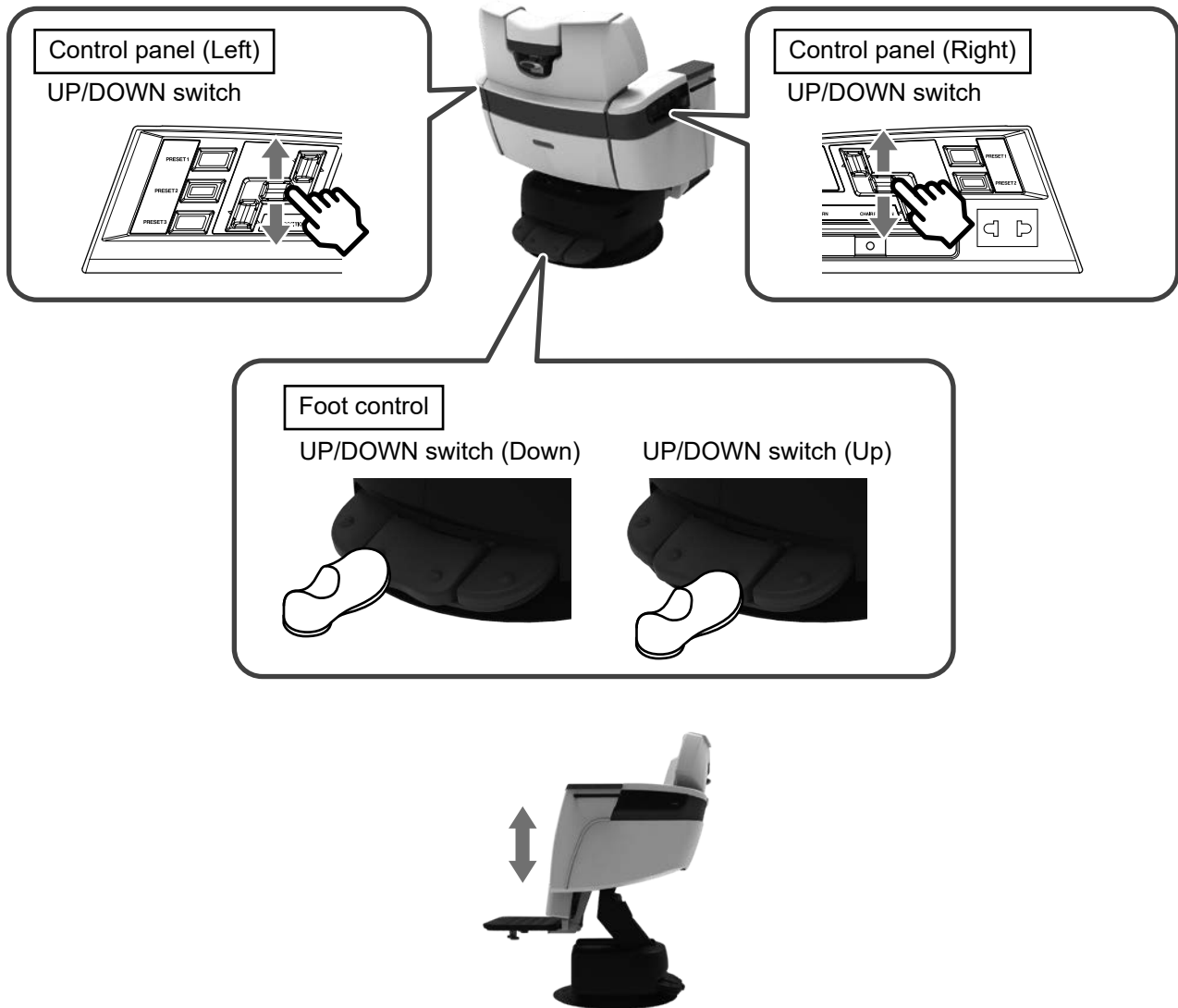

The chair moves up and down while a switch is pressed.

⇒ Even if the chair is unlocked, rotation mechanism will be locked before the chair is activated.

To fine-adjust the position

When lowering the chair, the position can be finely adjusted by pressing the switch little by little.

When raising the chair, first press the switch lightly to start the operation, then press the switch little by little to fine-tune the position.

WARNING

- When raising or lowering the chair, make sure that there are no person, hands, feet, or objects nearby before operating the chair. Especially when lowering the chair, be careful not to get your foot caught under the footrest.
- The body of this product moves backward as it moves up. Make sure that there are no obstacles in the front and back before operating the chair.

Reclining/Raising the Backrest

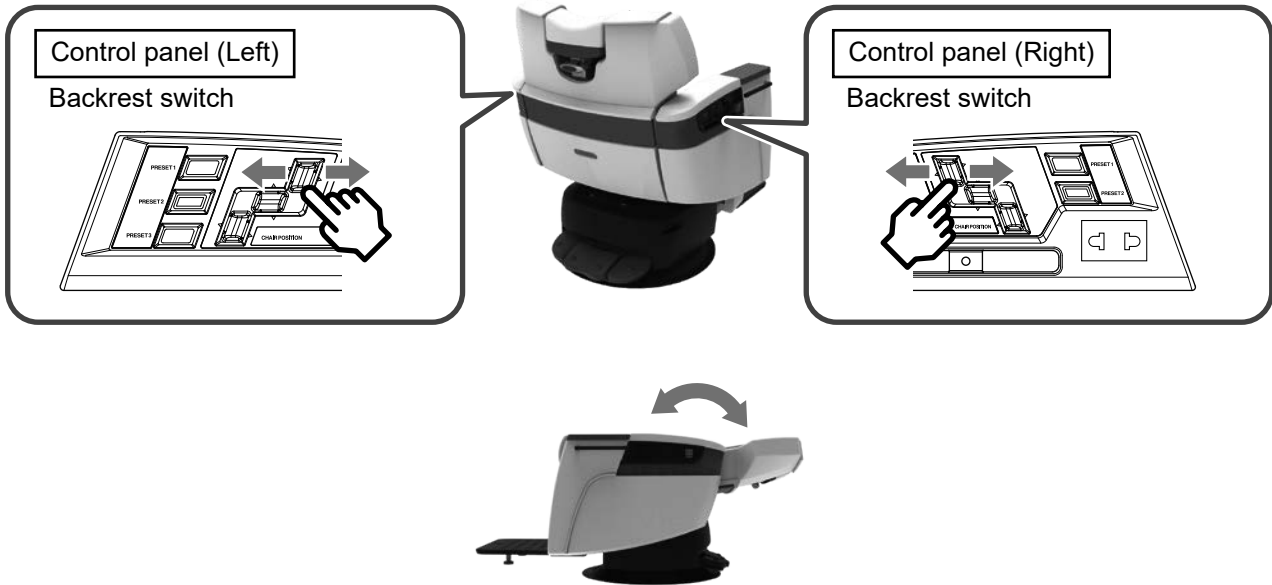

The backrest will recline/raise while the switch is held down.

⇒ Even if the chair is unlocked, rotation mechanism will be locked before the chair is activated.

To fine-adjust the position

When reclining the backrest, the position can be finely adjusted by pressing the switch little by little. When raising the backrest, first press the switch lightly to start the operation, then press the switch little by little to fine-tune the position.

When you recline the backrest without using the headrest when performing backwash, support the customer's head with your hand so that the customer will not contact with the shampoo bowl.

WARNING

- When raising/reclining the backrest, make sure that there are no hand or fingers of the customer between the backrest and the body/seat.
- Carefully recline the backrest so that the headrest or backrest will not contact any shampoo bowl or nearby equipment.
- When the backrest is laid down, the body lowers in conjunction with it. Be careful not to pinch your body or objects under the body or between the body and the pump cover.

Raising/Lowering the Legrest

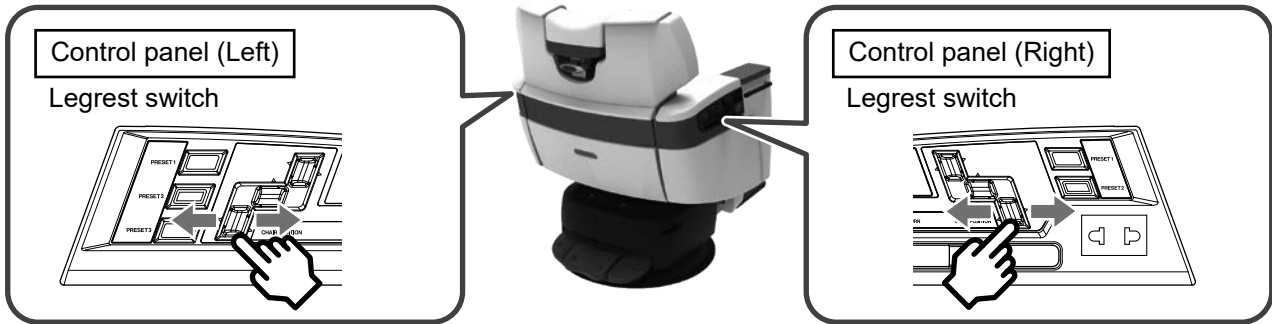

The legrest moves up and down while the switch is pressed.
The footrest is also moved up and down in conjunction.

⇒ Even if the chair is unlocked, rotation mechanism will be locked before the chair is activated.

To fine-adjust the position

When lowering the legrest, the position can be finely adjusted by pressing the switch little by little.
When raising the legrest, first press the switch lightly to start the operation, then press the switch little by little to fine-tune the position.

WARNING

- When raising the legrest, make sure that customer's toes or the footrest does not come in contact with peripheral equipment.
- When lowering the legrest, make sure that there is no person or object under the legrest or footrest.

Moving the Chair to Preset Positions

Using the preset function

Preset Function

Pressing the switch just once moves the chair to a preset position.
You can set up to three optional positions of this chair.

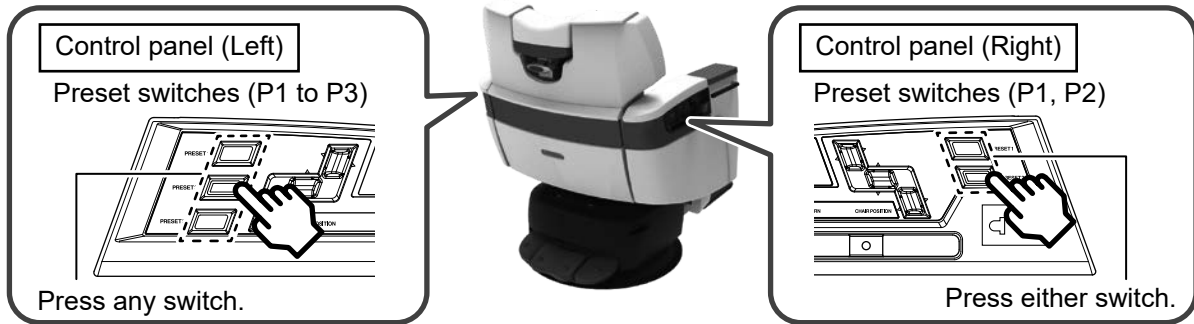

The chair, backrest, and legrest move to the preset positions.
The footrest is also moved up and down in conjunction.
For details on how to change the preset position, refer to (p. 23).

⇒ Even if the chair is unlocked, rotation mechanism will be locked before the chair is activated.

Moving the Chair to Preset Positions

Using the auto-return function

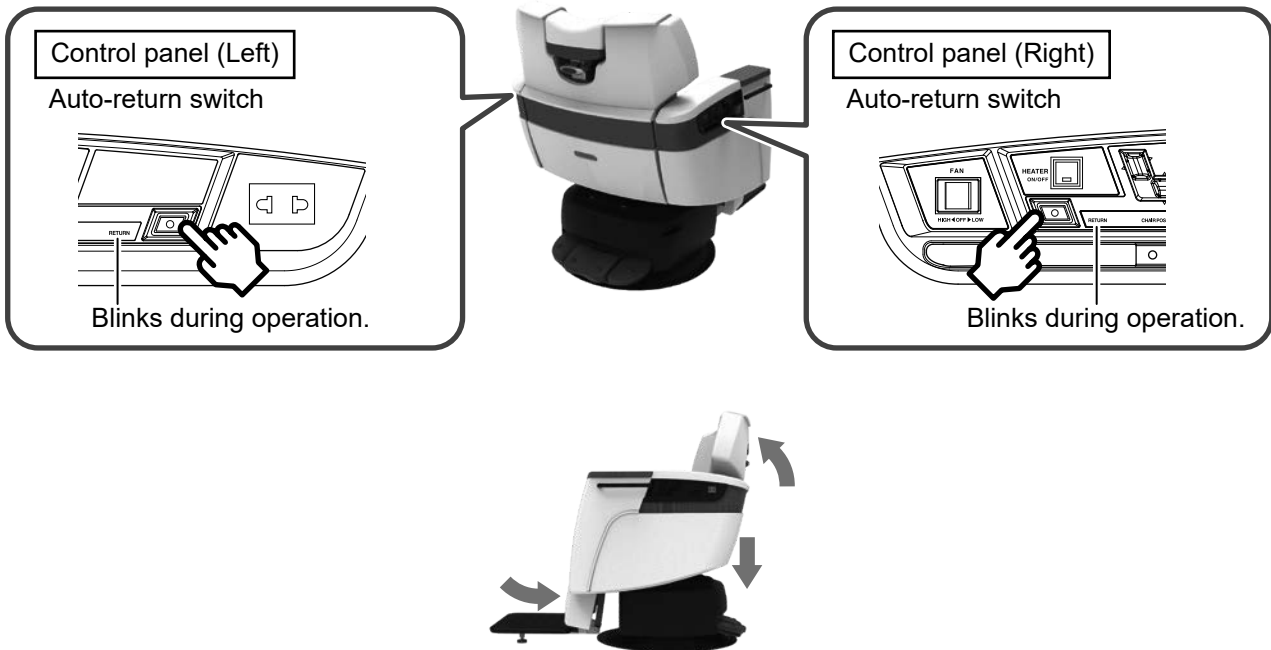

The chair, backrest, and legrest return to entry/exit position. Footrest also lowers in conjunction. (The "RETURN" indicator of the operating part blinks during operation.)
The beep sound notifies the start of operation as a warning.

⇒ Even if the chair is unlocked, rotation mechanism will be locked before the chair is activated.

WARNING

When using the preset or auto return function, check that there are no people's body, hand, foot, or objects in the vicinity, then operate the chair.

Canceling an operation

To stop the operation activated by the preset function or auto-return function halfway, press any switch on either the base operation part or main operation part. (Except for the heater switch and fan switch) (A beep sound will be generated when the auto-return operation is stopped (canceled)).

Moving the Chair to Preset Positions

Adjusting preset positions

Although the setting positions of the preset switches are previously set, you can change to the positions to match your needs and preferences.

Set the positions of the preset function with a person sitting in the chair.

The chair is equipped with a shockless device. Accordingly, the set positions vary slightly when a person sits in the chair if position setting is performed without a person sitting in the chair.

1. Move the chair to the desired seat, backrest and legrest positions, and turn the power switch off.
2. ① While pressing the preset switch you want to set,
② Turn on the power switch,
③ Press and hold the preset switch until a beep sound is generated (for about 3 seconds).
Is set at that position.

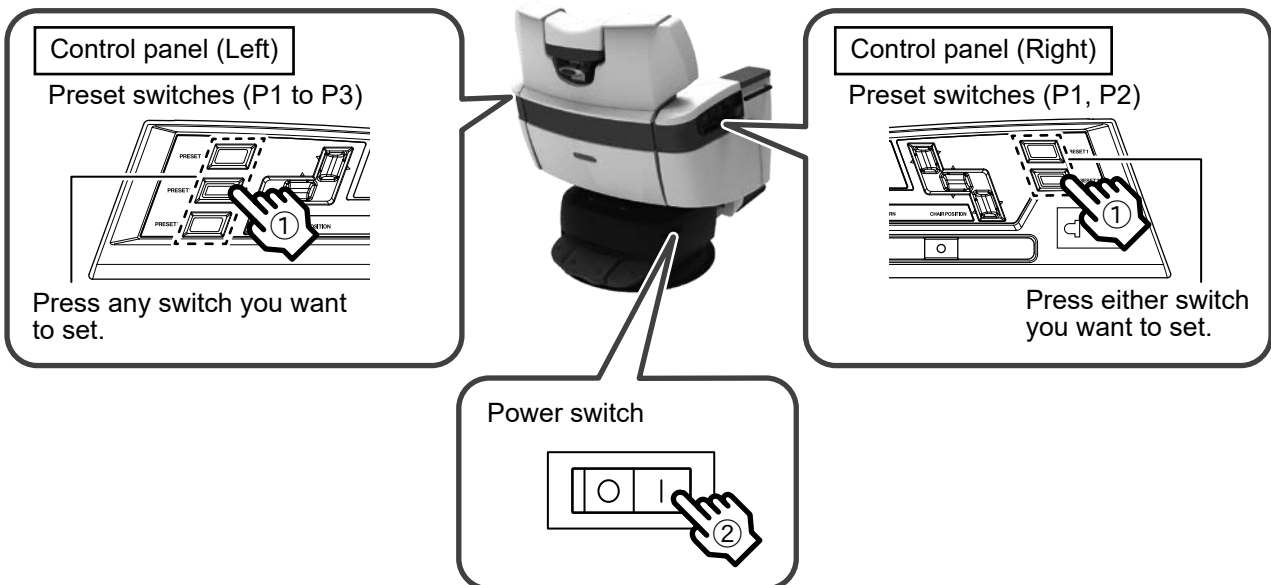

3. First, return to the exit/entry position with the auto return switch, then use the preset switch for which you have changed the setting to make sure that the chair moves to the position you have set.

Preset settings are not possible when the chair is within approximately 5 cm of the lower limit position and the backrest is reclined more than approximately 140 degrees (to prevent the chair body or backrest pinching feet and other objects).

If the setting operation is performed in this position, a 'beep' will sound and the setting will be set at a position approximately 5 cm higher than the lower chair limit position.

Moving the Chair to Preset Positions

Setting the fit mode

What is Fit Mode...

This product is equipped with a shockless device, which will cause slight variance in the stop position. Use this setting when you want to adjust the height to the bowl properly, such as when back shampooing.

1. Turn off the power switch, and - while pressing the preset switch*1 you want to set and the lowering switch (downward switch of the up/down switch) at the same time - turn on the power switch.

2. Press and hold the preset switch and the lowering switch (downward switch of the up/down switch) until a short beep sound is heard (for about 3 seconds).

The above action sets the Fit mode.

By repeating Steps 1 and 2, you can alternate ON/OFF *1 (when the fit mode is canceled, another beep sound is heard).

*1: This function can be set for each of preset switches 1 to 3.

*2: This function is set to "OFF" at the time of shipment from the factory.

When the Fit Mode is set, a slight shock will occur due to the different control of the chair to properly align the stop position.

Using the Cape Holder

Using the cape holder:

- Provides space between the customer and the cutting cape to provide good ventilation.
- Makes it easy to clean up the cut off hair.

1. Rotate the cape holder forward.

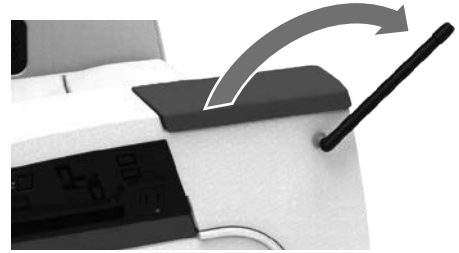

2. Pull out the tip of the cape holder and pinch the cutting cape between the parts.

① Pull from the top of the cutting cape

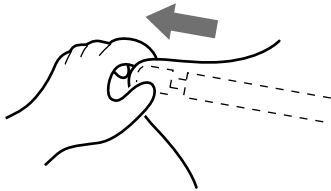

② Pinch the cutting cape and release

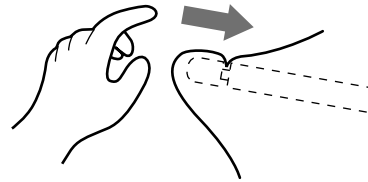

3. Rotate the cape holder rearward to store it.

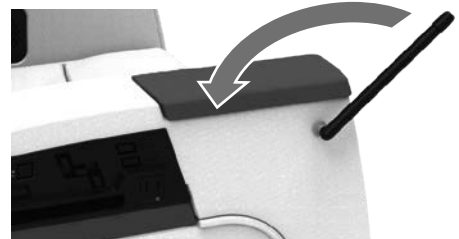

When using or storing the cape holder, hold and rotate it until it reaches its final position. Giving it a shock may make it loosened or damaged.

CAUTION

- Be sure to always return it to the stored state when not in use.
- When storing the cape holder, be careful not to pinch the customer's or your own fingers between it and the armrest.
- The cape holder can withstand a load of 1 kg. Using the holder with an excessive load can result in damage or injury.

Using the Dryer/Iron holder

Pull out the dryer/iron holder located on the right side.
Use it when hanging a hand dryer / iron temporarily.

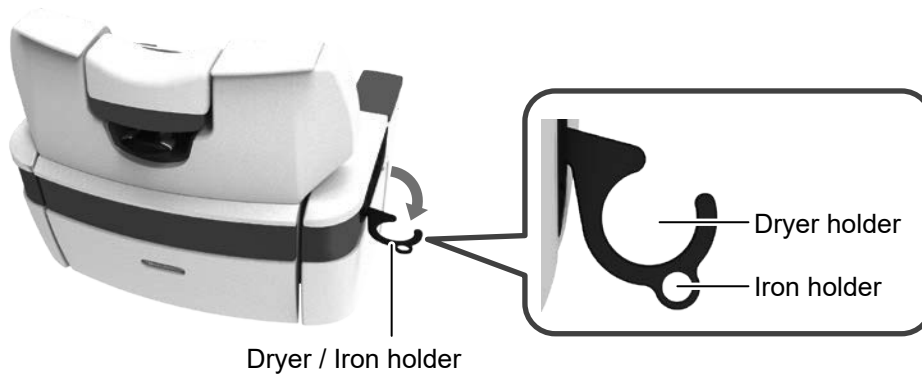

- Store the dryer/iron holder when not in use.
- Do not rotate the dryer/iron holder with a hand dryer or iron still inserted in the slot.
Doing so may damage the product or peripheral equipment, or deform/deteriorate it with heat.

CAUTION

- When using the dryer / iron holder, be careful not to let it touch the operator's foot.
- The dryer/iron holder can withstand a load of up to 5 kg.
Using the holder with an excessive load can result in damage or injury.

Using the Service Outlets

This chair is equipped with one service outlet each on the right and left control panels.

Total current available for use with the two service outlets is 12A or less when not operating the chair and 9A or less when operating the chair.

The power switch (breaker) is turned off if the current available for use is exceeded. If this occurs, stop using the device connected to the service outlet, and turn on the power switch (breaker) again.



WARNING

- Be sure to fully insert the power plug of the device being used into the outlet until reaching the base of the plug. Failure to fully insert the plug or similar loose connection can result in a short circuit or heat generation that causes a fire.
- If the connection becomes loose, immediately stop using the equipment attached to the service outlet and unplug the equipment from the service outlet. Contact your authorized Takara Belmont dealer as soon as possible for inspection or replacement parts.
- Remove the power plug of a device from the service outlet when not using it.
- If any water gets on a service outlet, immediately turn off the chair power switch, remove the plug, and wipe away the water. Additionally, if a substantial amount of water gets inside a service outlet, immediately remove the plug and contact your authorized Takara Belmont dealer.
- Do not touch a service outlet with a wet hand.
- If needed, use a suitable conversion adapter as AC250V 12A or higher.
- When a conversion adapter is used, make sure that it is firmly plugged into the service outlet. Loose connection can make the adapter heated up and lead to fire.

About shockless move

This product is equipped with a shockless mechanism that allows gentle starting/stopping movement, which softens the vibration and smooths the movement, improving tranquility.

Warm up mode

The hydraulic system and shockless mechanism employed by the product may make the chair stopping position slightly vary depending on the oil temperature and customer's weight.

When the oil temperature of the hydraulic oil is low especially in the morning of winter, the stop position may vary greatly.

For this reason, when the oil temperature is significantly low, the chair preheating function will start immediately after the product's main switch is turned on.

The warning sound will beep during the 3-minute preheat operation. To cancel the chair preheating function during its operation, press any switch (except for heater switch and fan switch) at the base operation part or the operation part.

Properly adjusting backwash position

The shockless mechanism employed by the product may make the chair stopping position slightly vary depending on the oil temperature and customer weight. If the preset function does not bring backrest to proper position at the shampoo bowl for backwash, setting to adjust to proper position is possible. Refer to "Setting the fit mode" on page 24 and change the setting.

Using the Heater

This chair is equipped with a function to warm the legrest and backrest.

Press the heater switch to operate the heater. (The lamp of the switch lights up.)

When the heater is in operation, its automatic temperature adjustment function heats the chair at an appropriate temperature.

Press the switch again to stop the heater. (The lamp of the switch turns off.)

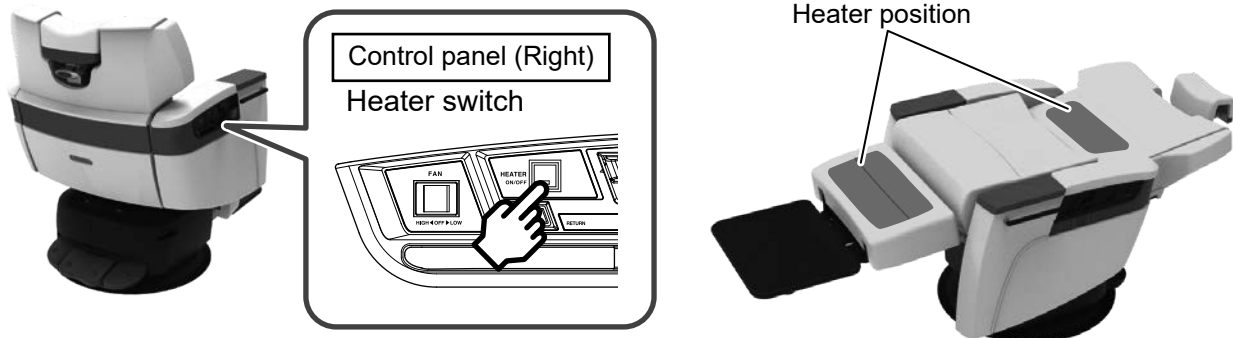

Use the heater with the legrest raised because heat will escape and the effective temperature will be reduced if the customer's calves do not contact the legrest.

WARNING

- Be sure to turn off the heater switch when not necessary. Using the heater for an extended period causes the temperature to increase, possibly resulting in burns or fire.
- Do not use the heater for a long time. Doing so may cause low-temperature burns. Should red spots or blister occur, immediately take the diagnosis of a medical specialist.
- If you notice abnormal heat when using the heater, turn off the power switch, unplug the equipment, and contact your authorized Takara Belmont dealer.

Using Fans

This product can operate fans inside the armrest at customer's request.

Push the fan switch to LOW. The fan will produce soft air flow (Fan switch lights up in green).

Push the fan switch to HIGH. The fan will produce strong air flow (Fan switch lights up in green).

The fan will not operate when the backrest is reclining over 120°(because the body is lowered and the fan outlet is covered).

To resume the fan function, raise the backrest higher than 120°, turn the fan OFF, and then turn it LOW or HIGH.

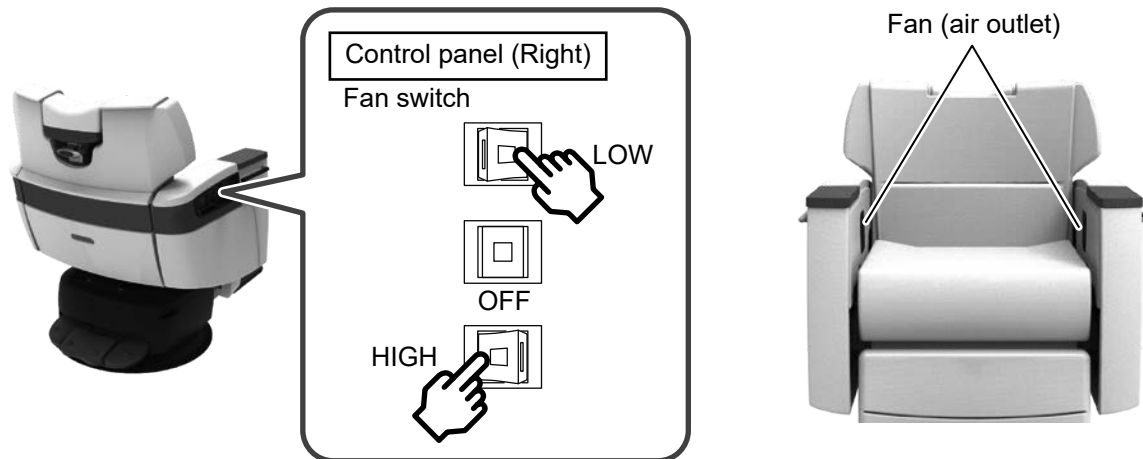

Turn off the fan switch to stop the fan (Fan switch light goes off).

Automatic fan stop function

The fan automatically stops in the following situations:

- When the operation continued for more than 8 minutes
- When the backrest reclines at 120° or more

To start the fan again...

To resume the fan function, raise the backrest higher than 120°, turn the fan OFF, and then turn it LOW or HIGH.

Even if the fan is not used for a long period of time, operate the fan once a month. If dust or hair accumulates inside the fan, dust or hair may come out when the fan is running, or the fan itself may cause malfunction.

CAUTION

When using the fan, make sure that the customer is not hanging a small object such as a key or a portable strap on the waist. If foreign matter enters into the air outlet of the fan inside the armrest may cause failure of the fan or property damage.

Using the fold-out table

Attach the provided protective sticker (for preventing scratches) to the armrest and fold-out table before use. (Refer to the separate sheet "DIVAN-Z Attaching the provided protective stickers")

1. Pull out the table straight up, holding the armrest (sitting right) with both hands until the end.

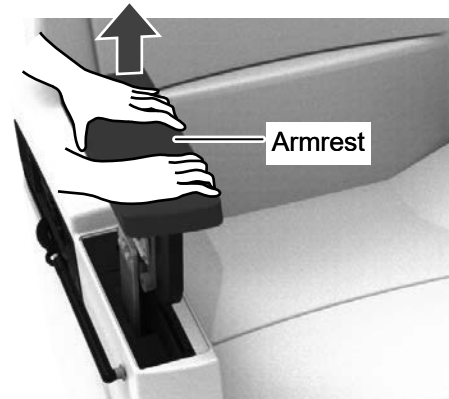

2. Rotate 90° at the highest position.

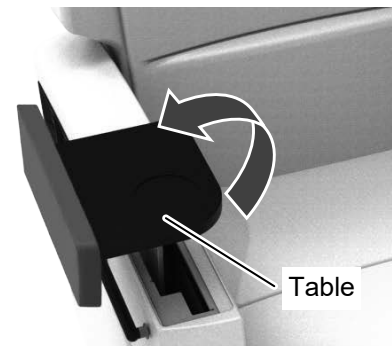

3. Lower the table to the lowest position to set the table.

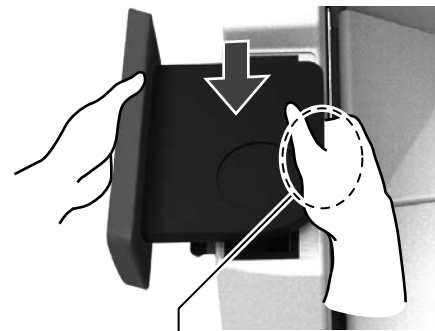

Be careful not to get the fingers/hands caught in the table.

When storing the table, follow the steps in reverse.

- Do not move the table or operate the product with objects placed on the table. Doing so can result in such items falling off or in spilling of liquids.
- Do not place objects on the table that weigh 2 kg or more, or items that hang over or extend beyond the table surface. Doing so can result in damage to or deformation of the chair or table.
- When rotating or operating the chair with the table set, be careful not to let the table come into contact with peripheral equipment.
- Do not apply load from above the table with the table set.

CAUTION

When inserting or pulling out the table, hold it with both hands until the end and operate it slowly. Be careful not to get the fingers/hands of customer/operator caught in the retractable table.

Using the Foot Cushion (Optional)

This chair has a foot cushion that can be placed on the footrest on which the customer's legs can rest in order for the customer to recline with comfort.

Place the foot cushion with the zipper side down.

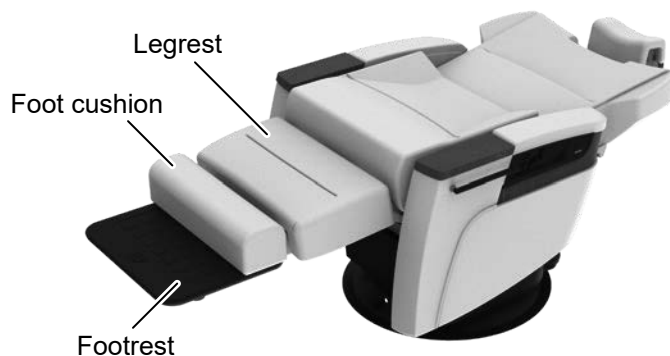

Always be sure to remove the foot cushion before returning the legrest to its original position. Returning the legrest with the foot cushion still located on the legrest can result in the cushion being pinched between the legrest and footrest.

CAUTION Remove the foot cushion from the footrest when the customer gets in and out of the chair. Otherwise the customer may fall over causing injury.

Using the Footrest Pad (Optional)

You can place a footrest pad on the footrest to help customer sit comfortably.



Removing the Footrest

You can remove the footrest anytime it might interfere such as when sitting a wheelchair customer in the chair or using a foot spa machine.

Attaching/detaching the footrest

Detaching the footrest

Pull up the footrest at an angle with both hands and pull it up towards you to remove it.



Attaching the footrest

- ① Insert the footrest bracket into the hole of the footrest mount.
- ② Slide the footrest bracket to the back until it hits the stoppers.
- ③ Lower the footrest.
- ④ Make sure the footrest is level.

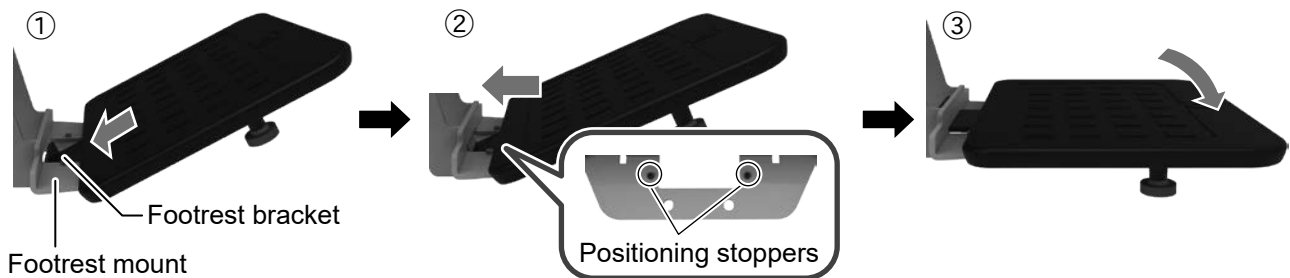

Adjusting the adjuster height

The adjuster, which prevents the chair from tipping over, is located on the underside of the footrest.

Adjusting the adjuster height

- ① Loosen the adjuster nut with wrench (opposite side 17mm) by turning it counterclockwise.
- ② Adjust the height by rotating the adjuster. counterclockwise → heighten clockwise → shorten
- ③ Fasten the adjuster nut with wrench (opposite side 17mm) by turning it clockwise.

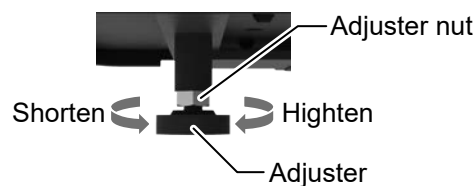

⚠ WARNING

- After installing the footrest, make sure that the footrest bracket is firmly hooked to the footrest mount and that the footrest is kept level. Failure to do so may result in injury.
- Be careful when lifting and carrying the footrest, and of where you place it because the footrest is heavy. Dropping the footrest could result in injury or damage the floor.

⚠ CAUTION

When adjusting the height of the adjuster, make sure that the adjuster does not rub on the floor or catch the power cord when the chair is rotated. On the contrary, adjust the height so that the product does not fall over even if the customer gets on the footrest at exit/entry position.

Cleaning Procedures

Clean this chair after use to maintain it in a clean state.

Leaving dirt or grime on the chair can result in the formation of mold.

WARNING

- Turn off the power switch and unplug the power plug before cleaning. Failure to do so can result in electric shock or fire. Unexpected activation of the product may cause injury.
- Do not sprinkle with water to clean it. Washing in such a manner can result in a malfunction or electric shock.

CAUTION

The metal and mechanical parts of the chair have sharp edges. Be careful when cleaning the chair that your hands, fingers or other body parts are not injured.

Cleaning of Each Part

Leather Parts **Wooden parts** **Plastic Parts**

Lightly wipe clean using a dry soft cloth.

If extremely dirty

Wipe off any stain by using a soft cloth that has been dabbed with a neutral detergent diluted with water to approximately 10%, wipe it with a damp cloth and thoroughly wipe it dry.

Control Panels **Metal Parts**

Wipe clean using a dry soft cloth.

Do not clean these parts with a wet cloth because they are readily affected by moisture and water. Wipe off all moisture immediately if any water gets on these parts. Water left on these parts will result in deterioration, rust, and malfunction of electronic parts.

- Do not use any of the following substances to clean the chair.
Thinner, alcohol, nail polish remover, volatile chemicals (such as gasoline or kerosene), acid or alkaline solutions, chlorinated cleaners, disinfectants that are highly corrosive to metal, povidone iodine (iodine solution), sodium hypochlorite, waxes containing abrasive compounds, sponges containing abrasive compounds and similar substances.
- Do not use brushes, scouring brushes or similar items when cleaning the chair. Using them will damage the chair or result in the inability to clean off the dirt or grime.
- Do not clean leather parts using a cleaner or bleach containing organic solvent or abrasive compounds. Such substances can cause the leather surface to deteriorate or dull the luster.

Clean a chair that has not been used for an extended period before using again.

After cleaning, be sure to always check that the chair operates properly.

Spray-type Hairstyling Products (Especially hard types)

When using spray-type hairstyling products (especially hard types), check the entire chair to make sure that none of the product is adhering to the exterior surface of the chair (including leather parts). Immediately wipe off any hairstyling product that is adhering to the chair. Allowing such hairstyling product to remain results in it becoming firmly adhered, leaving a feeling of roughness. Be especially careful of flat surfaces (such as the plastic covers) as this roughness is considerably noticeable on flat surfaces.

* If hairstyling product has become firmly adhered:

Clean off any firmly adhered hair product by using ethanol. However, repeatedly cleaning off product adhering to plastic covers and leather parts by using ethanol can cause the surface to deteriorate, paint to peel, the luster to be lost, and cracking. To prevent this, immediately wiping off any adhering hairstyling product is the best method to prevent any problems.

Troubleshooting

If any of the problems described below occur, conduct the checks outlined before requesting repair. If the chair does not work normally even after performing the recovery procedures, immediately stop using the chair, turn off the power, unplug the power plug, and contact your authorized Takara Belmont dealer.

Problem	Check Points	Recovery Procedures
Chair does not move.	Is the power plug fully inserted to the base of the plug?	Fully insert the power plug into the outlet until reaching the base of the plug. (p. 14)
	Is the power switch turned on?	Turn on the power switch. (p. 14)
	Has a fuse of the shop's switchboard or breaker been tripped?	Replace the fuse of the switchboard or turn on the breaker.
	Has the chair been operated for an extended period continuously?	The problem is due to the operation of the overheating prevention device. ⇒ Wait for about 10 minutes and try again. Overheating Prevention Device This is a protective circuit that prevents abnormal overheating of internal mechanisms due to continuous operation and similar causes. The chair might stop moving temporarily.
The power switch turns off when using the service outlet.	Is the total amount of current used less than the allowable value?	The breaker function operates if the current used exceeds the allowable value. Use an amount of current that is less than the allowable value, and turn on the power again so that the chair will operate normally. Breaker Function This function prevents damage to this chair if the chair is used when the allowable current is exceeded.
	Has there been a short circuit in one of the devices connected to the service outlet?	Switch to using a different device and try turning on the power switch.
Fan does not operate.	Isn't the backrest reclining more than 120°?	Raise the backrest to be less than 120°, and operate the fan switch again. (p. 29)
The fan stops	Isn't operation for more than 8 minutes?	This is due to the operation of the automatic stop function. When the backrest is reclined more than 120°, raise it to be less than 120°, and operate the fan switch again. (p. 29)
	Isn't the backrest reclined more than 120°?	

These are not malfunctions	
Sound at startup	Such sound is due to the internal hydraulic fluid being cold. It is not a functional fault and should stop shortly thereafter.
Slow movement of the chair	Such movement is due to the internal operating fluid being cold. Raise the room temperature or continue operating for a short period. It will recover to the normal condition.
Sound when rotating the chair	This is the sound of the steel balls rolling when the chair is rotated. The level of this sound varies depending on the environment where the chair is installed.

Daily Inspection

Perform the following inspection procedures in order to ensure that the chair can be used safely. If the chair does not operate normally, stop using the chair, turn off the power, unplug the power plug, and contact your authorized Takara Belmont dealer.



WARNING

Be sure to always perform daily inspection according to the following instructions. Failure to do so may result in injury or damage to peripheral equipment or facilities.

Daily Inspection Procedures

Inspection Item	Inspection Procedures	Recovery Procedures if there is a Problem
Does the chair operate normally?	Turn on the power switch, and confirm any warning beep does not sound other than that for the warm-up mode (p. 28).	Turn off the power switch, wait for about 5 seconds, then turn on the power switch again. If the alarm still sounds, contact your authorized Takara Belmont dealer.
	Check that there is no rattling or abnormal noise when operating the chair.	If there is any abnormality, contact your authorized Takara Belmont dealer.
	Check that the chair moves normally to the preset positions by using the preset switches.	Perform the procedures indicated in "Using the preset function" (p. 21). If the product does not operate normally, contact your authorized Takara Belmont dealer.
	Check that the chair moves normally to the initial position (entry/exit position) by using the auto-return switch.	Perform the procedures indicated in "Using the auto-return function" (p. 22). If the product does not operate normally, contact your authorized Takara Belmont dealer.
	Check that the chair raises and lowers by using the UP/DOWN switches.	Perform the procedures indicated in "Raising/Lowering the Chair" (p. 18). If the product does not operate normally, contact your authorized Takara Belmont dealer.
	Check that the chair backrest can be reclined and raised by using the backrest switch.	Perform the procedures indicated in "Reclining/Raising the Backrest" (p. 19). If the product does not operate normally, contact your authorized Takara Belmont dealer.
	Check that the chair legrest can be raised and lowered by using the legrest switch.	Perform the procedures indicated in "Raising/Lowering the Legrest" (p. 20). If the product does not operate normally, contact your authorized Takara Belmont dealer.
	Check that chair rotation can be locked and unlocked by using the rotation lock switch.	Perform the procedures indicated in "Rotating the Chair" (p. 15). If the product does not operate normally, contact your authorized Takara Belmont dealer.
	Check that the chair stops at the desired position for a fixed period and does not continue to go lower.	If the chair does not stop for a fixed period and rather continues to lower, contact your authorized Takara Belmont dealer.
	Check that the heater becomes warm by the heater switch.	Perform the procedures indicated in "Using the Heater" (p. 28). If the product does not operate normally, contact your authorized Takara Belmont dealer.
Check if soft and strong wind is generated by the fan switch.	Perform the procedures indicated in "Using fans (p. 29). If the product does not operate normally, contact your authorized Takara Belmont dealer.	
Are there any abnormal odors being emitted?	Check that no abnormal odors or smoke are being emitted from the chair.	If abnormal odors or smoke are being emitted, contact your authorized Takara Belmont dealer.
Check that no oil is leaking.	Check that no oil has dripped on the top of the base and oil is not seeping from the pump cover.	If oil is leaking, contact your authorized Takara Belmont dealer.

Standard Period of Use

The standard period of use of this chair is 10 years.

The standard period of use is "an approximate standard period for which the chair can be safely used with no impediments to safety under the standard use conditions for each chair and while performing proper maintenance and inspection (including parts replacement)". This is not a warranty period.

The length of the "standard period" differs depending on the use environment and frequency of use of the customer.

For maintenance after the standard period of use, contact your authorized Takara Belmont dealer.

Disposing of this Product

Dispose of this chair and replaced parts in a proper manner that complies with local laws and regulations.

Specifications

Model no.	AB-DVZF
Weight	155kg
Seat	Electrohydraulic system
Initial height/stroke	510/280 mm
Maximum lifting capacity	135 kg
Headrest	Manual type
Backrest	Electrohydraulic system
Legrest	Electrohydraulic system
Upholstered part	Synthetic leather
Operating switches	Switches of the base operation part and the operation part
Use environment	Temperature 0 - 40°C
	Humidity 10 - 95% (No condensation)
	Air pressure 700 - 1060 hPa
Transportation/Storage environment	Temperature -20 - 70°C
	Humidity 10 - 95% (No condensation)
	Air pressure 700 - 1060 hPa

Rated voltage	AC 110 V	AC 120 V	AC 220 V	AC 230 V	AC 240 V
Rated frequency	60 Hz	60 Hz	50/60 Hz	50 Hz	50 Hz
Rated current	5.4 A	5.4 A	2.9/3.0 A	3.1 A	3.2 A

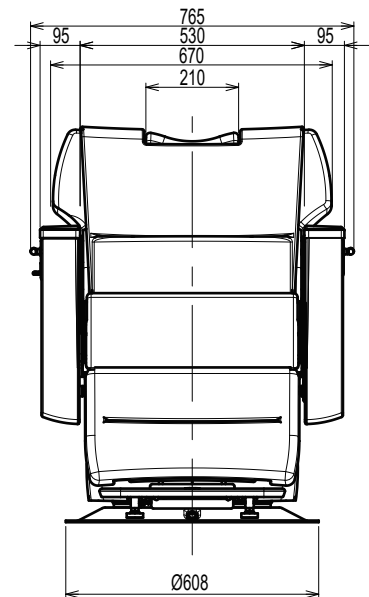
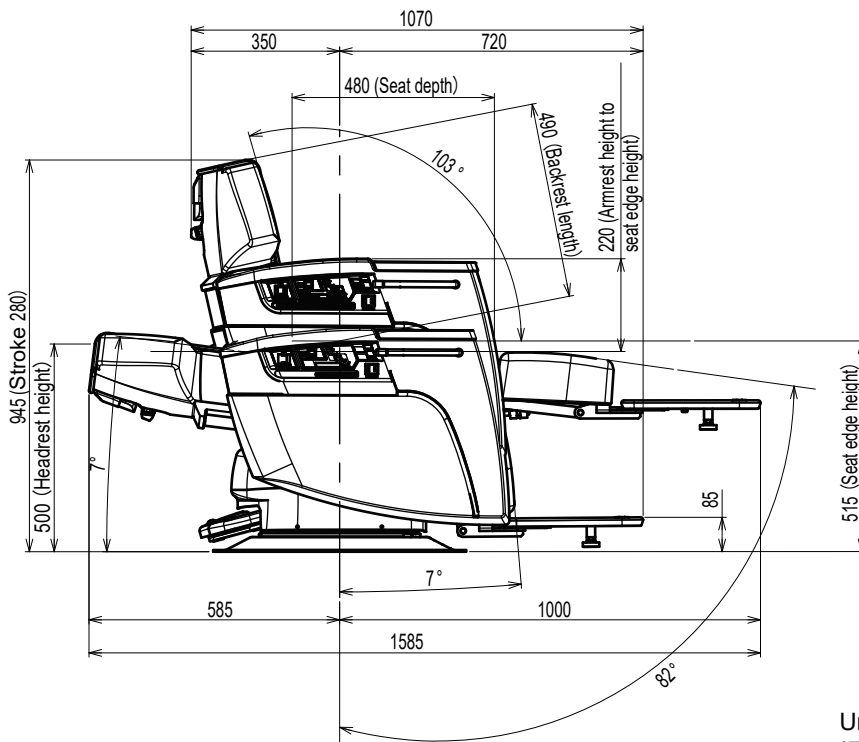

Unit: mm (Dimensional tolerance:±10%)
 *The specification is subject to change without notice.

NOTE

NOTE

MANUFACTURER



TAKARA BELMONT CORPORATION

2-1-1, Higashishinsaibashi, Chuo-ku, Osaka, 542-0083, Japan
TEL : +81-6-6213-5945 / FAX : +81-6-6212-3680