

- Carefully read this Installation Manual before installation/assembly and conduct installation/assembly in accordance with the installation procedures.
 - Hand over this manual to the customer after completion of installation/assembly.
 - Check the inclusion of following accessories when the package is opened.
 - Accessories
 - Operation Instructions • Installation Manual
 - Headrest (Only model No.AY-OAYMM) • Step
- *A cushion is not included (sold separately)

Installation Procedures

1. Convey the chair to the designated position.

- Remove the bolts for the crate and remove the sides and top of the crate. Move the chair by holding the crate. (Carrying only the chair part is dangerous because the base could come off and drop.)
- When the chair is removed from the crate, cut the banding bands that secure the chair on the crate using nippers. (Two banding bands are secured on each left and right armrest.)
- After cutting the banding bands, hold the base by two persons when moving the chair. Do not hold the pedal or chair body.

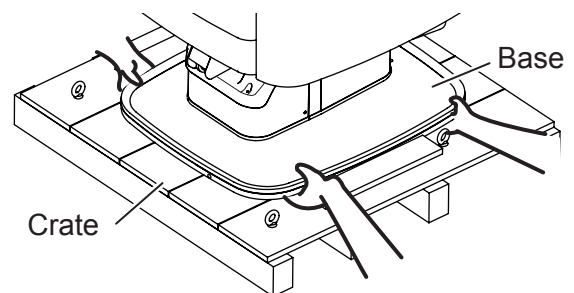
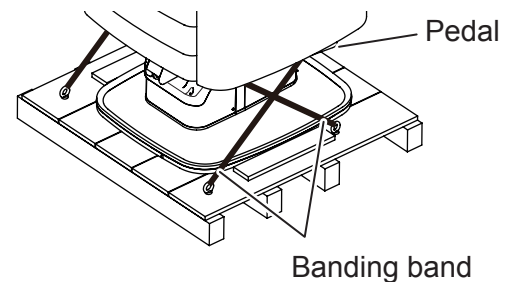
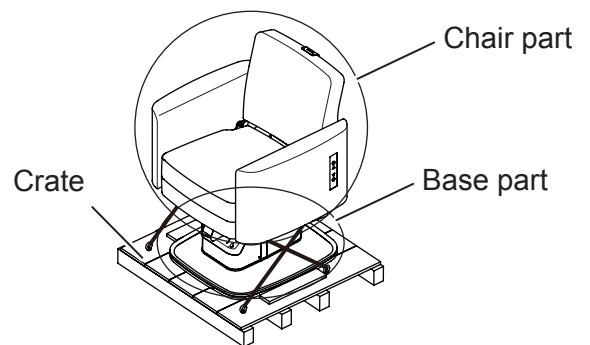

Warning

Pay attention to the position for holding when the chair is moved.

When moving this product, hold the chair base firmly. Carrying only the chair part is dangerous because the base could come off and drop.

Caution

- Hold the base while conveying or positioning. At that time, pay attention that the base sash doesn't come off.
- When placing on the floor, confirm that the power cord is going through a notch on the base sash.

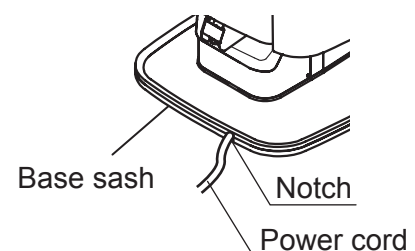

OASIS CHAIR Mee Installation Manual

<When using with YUME OASIS>

Confirm the shampooing technique adopted by the salon where the product is installed.
 If the flat shampooing or side shampooing is adopted, change the preset positions for the chair according to the "Change of Presetting Positions" [page 6].
 (If the lie-flat shampooing is adopted, it is not necessary to change the setup because the factory-configured setup is the lie-flat shampooing.)
 After changing the setup, install the chair according to the corresponding position in the figure below.

●Lie-Flat Shampooing (YUME OASIS : Model AY-OAYMYM)

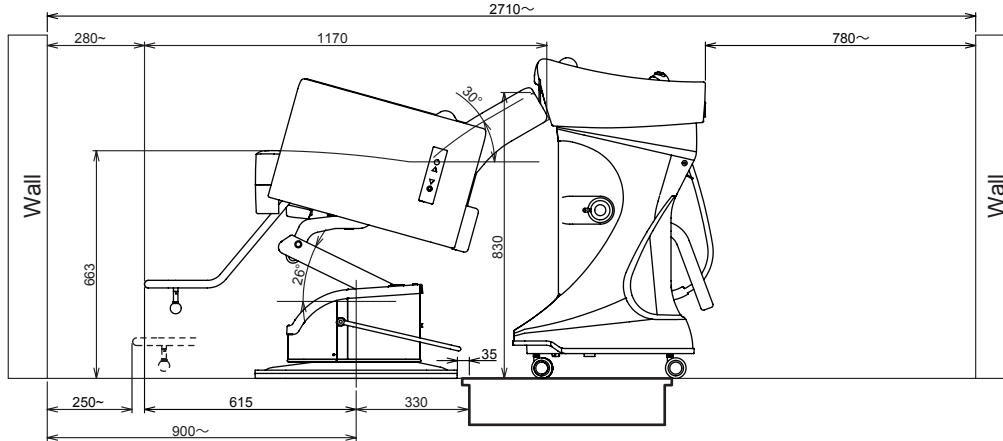

●Flat Shampooing (YUME OASIS : Model AY-OAYMYM)

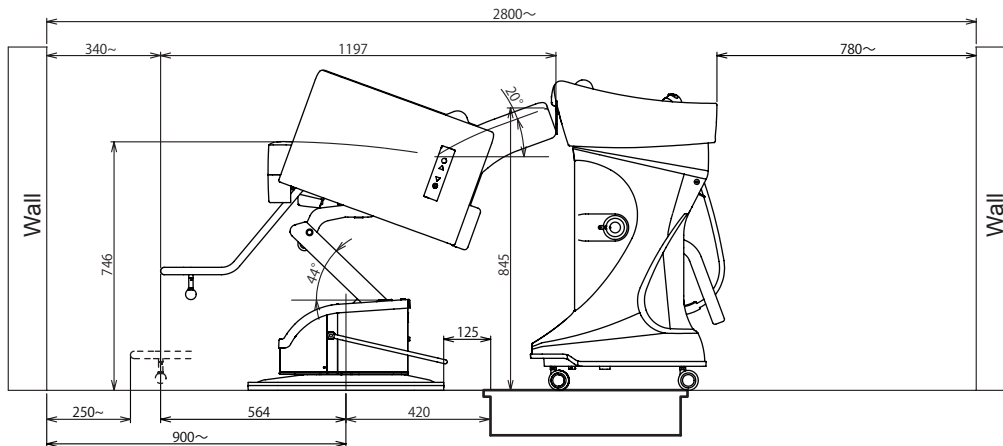

●Side Shampooing (YUME OASIS : Model AY-OAYMSS)

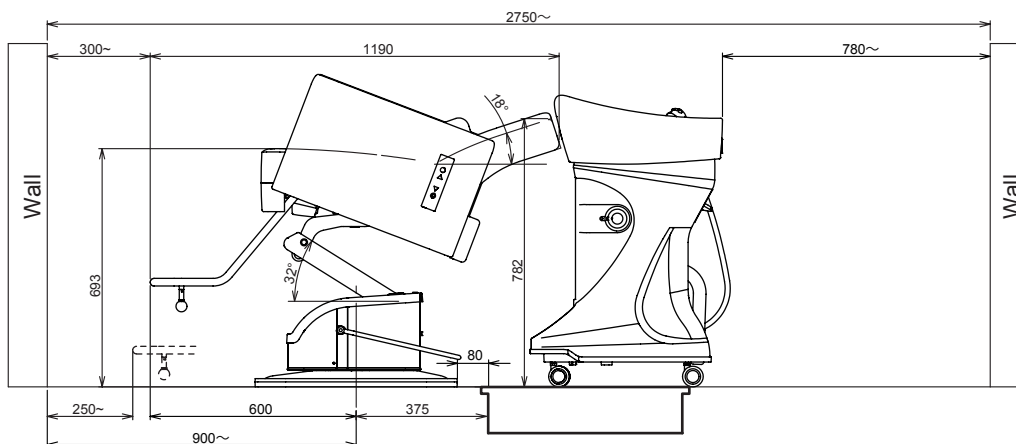

[Unit : mm]

OASIS CHAIR Mee Installation Manual

2. Attach the step

Attach the step contained in the package case on the waist panel using four fastening screws.

Fastening screws

- Upset bolt M8×30 4 pcs
(*Temporarily fastened on the waist panel.)

Step

(*Contained in the package case in the assembled condition.)

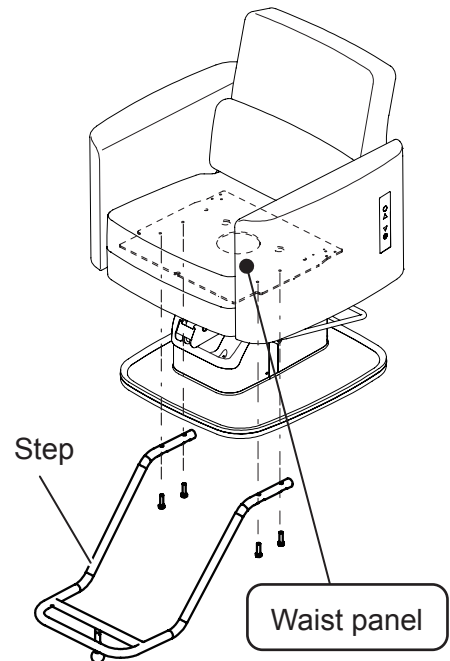

An adjuster is mounted on the step for overturning prevention. After attaching the step, set the adjuster at 25mm gap from the floor according to the following explanation.

1 Loosen the nut

Turn the nut CCW and loosen using a spanner (width across flats 13 mm).

2 Set up to acquire approximately 25 mm of gap between the adjuster and the floor (at the lowest position of chair)

Turn the adjuster for setting the height (Turn the adjuster clockwise [CW] for raising and turn counterclockwise [CCW] for lowering).

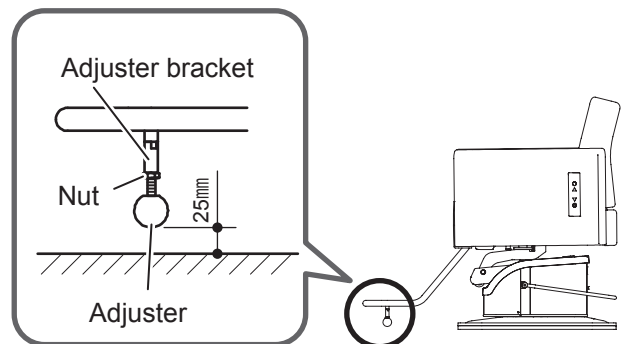

3 Securely tighten the nut

After adjusting the height, turn CW and securely tighten the nut using a spanner.

⚠ Warning

- After attaching the step, confirm the eliminated backlash. If the backlash remains, there is a risk of falling of the customer due to the instability when getting on/off.
- As the step has considerable weight, be careful when installing. Falling this may cause the injury or the damage to the floor.

⚠ Caution

When the adjuster is extended, pay attention to not scuffing on the floor or hooking the power cords with the adjuster when turning the chair.

OASIS CHAIR Mee Installation Manual

3. Connect the power plug to an outlet.

Prepare an outlet with a grounding terminal.

Be sure to connect to the ground.

Be sure to connect to the ground for the purpose of prevention of accidents caused by the electrical leakage and the enhanced anti-noise performance of control circuit.

Our company assumes no responsibility on electrical leakage accidents caused by the use without connecting to the ground.

<Connecting to the outlet under the base>

If the connection to the outlet is located under the base, arrange the pullout position of outlet, power cord, and power plug within the hatched area in the figure below because it is necessary to avoid the components inside of the base.

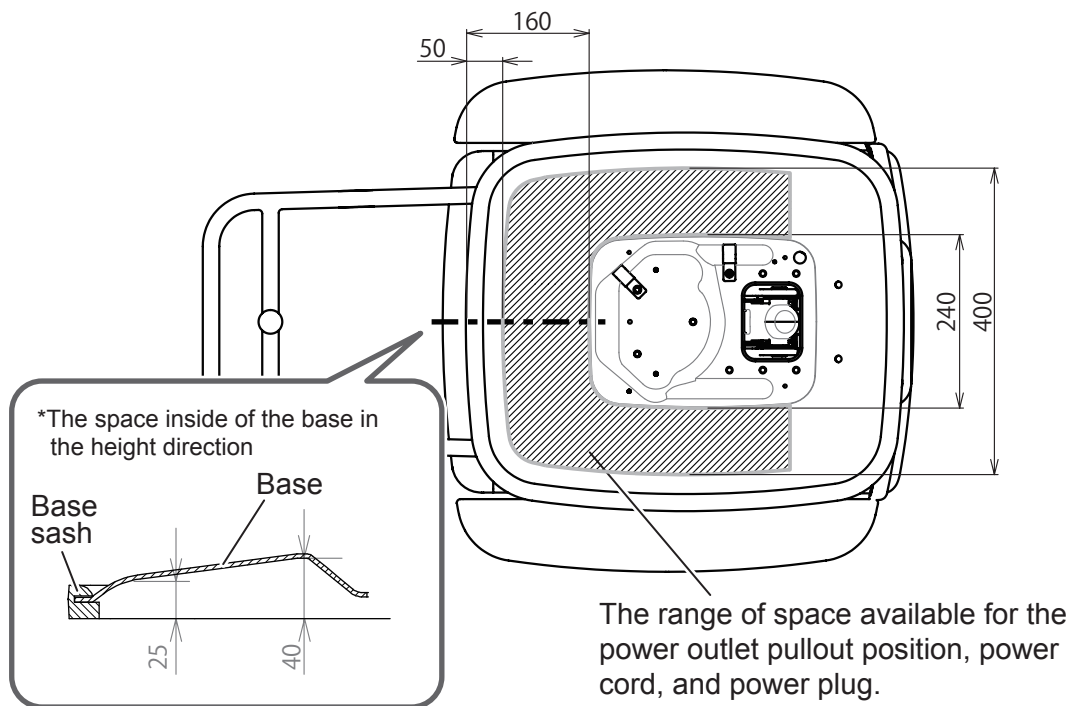

Warning

- For prevention of humidity coming from under the floor into the base cover, apply a proper anti-humidity treatment (dew condensation prevention, etc.). There is a risk of rusting or breaking.
- Check for no interference of power outlet pullout position, power cord, or power plug with base or other components. If interfering, promptly move those to a position where no interference occurs. There is a risk of electrical leakage or ignition.

4. Confirm if the chair operates properly.

Turn the power switch ON, confirm if the functions of the seat raising/lowering, the backrest raising/lowering, the preset and the auto return operate properly.

OASIS CHAIR Mee Installation Manual

5. Setting the preset position

The preset positions are already set up but can be changed to a desired working position.

- 1 Move the seat and the backrest of chair to a desired setting position and turn the power switch OFF then.**
- 2 Turn the power switch ON while pressing the preset switch.**
- 3 In this condition, keep pressing the preset switch for five seconds.**
The “beep” sounds, and the position is memorized as the setting position.

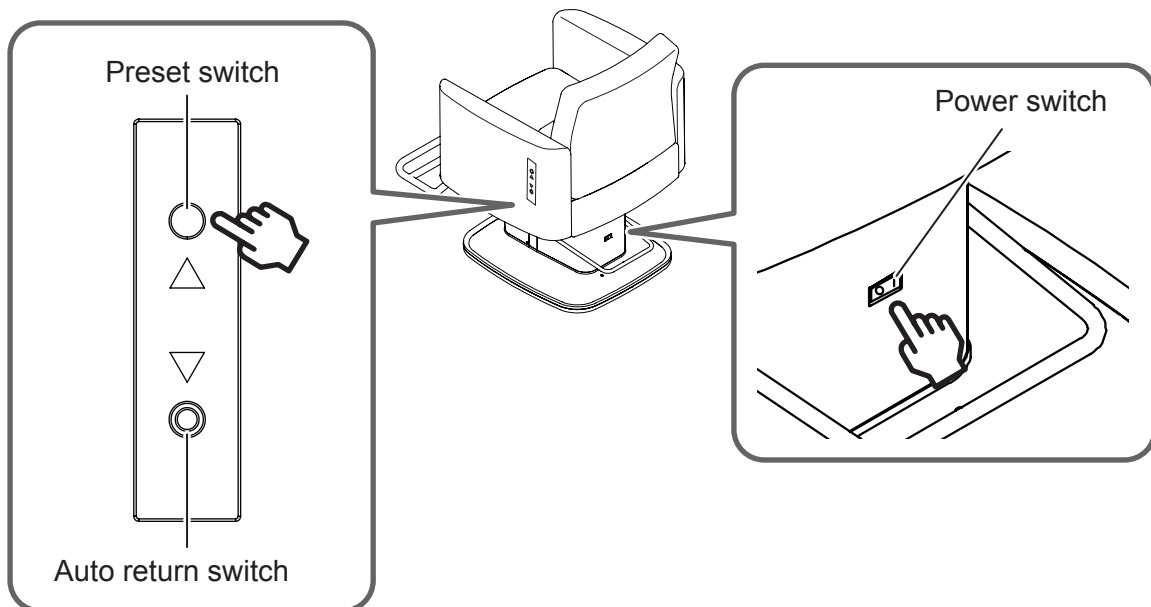

- 4 Return the chair to the getting on/off position using the auto return switch, then press the preset switch and confirm the setup position.**

OASIS CHAIR Mee Installation Manual

<Change of preset position according to the YUME OASIS>

Conduct in accordance with the following procedures:

- 1 Turn OFF the power switch
- 2 Turn ON the power switch while pressing a desired shampooing posture in the figures below.

•Lie-Flat Shampooing

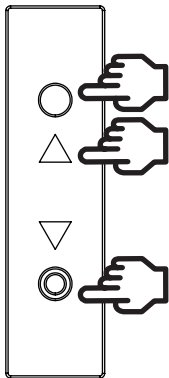

•Flat Shampooing

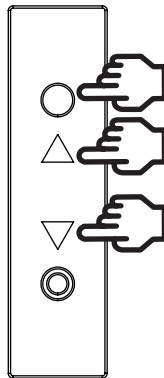

•Side Shampooing

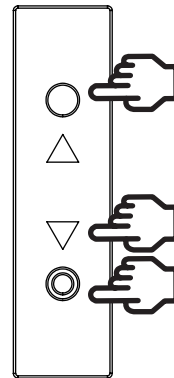

*What are the Lie-Flat and Flat Shampooings?

Shampoo techniques which is provided by stylist or assistant standing behind the basin.
(Rear position)

(The lie-flat shampooing is intended for an installation in a reduced space; accordingly, the backrest is raised more than that for the flat shampooing.)

*What is the Side wash shampooing?

Shampoo technique which is provided by a stylist or an assistant standing next to the basin.

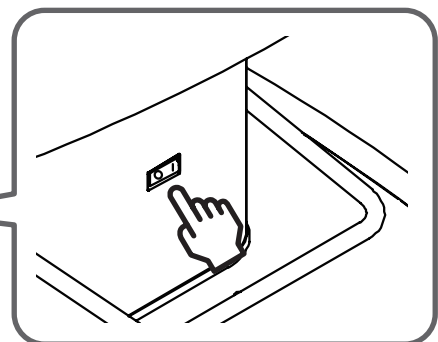
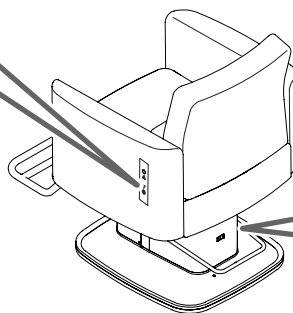

- 3 Keep pressing for five seconds.

The “beep” sounds, and the position for the desired shampooing posture is memorized as the setup position.

- 4 Return the chair to the getting on/off position using the auto return switch, press the preset switch and confirm the setup position.

Confirm the positional relation of YUME OASIS and the chair [page 2]. If the setup position is to be finely adjusted, finely adjust the chair position and reset the preset position according to the procedures in [page 5].

OASIS CHAIR Mee Installation Manual

<Model with headrest (AY-OAYMM) >

6. Mount the headrest.

Insert the headrest supporting frame in the headrest inserting hole while pressing the headrest operation button.

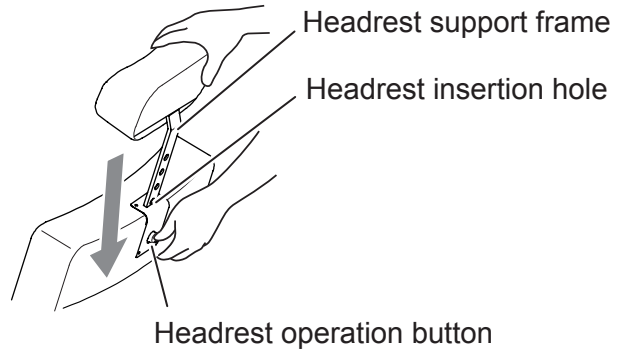

Warning

Confirm the correct insertion of headrest supporting frame in the headrest insertion hole.

